



### Legend

- Flood Mitigation Devices
- Culverts
- Headwalls
- Stormwater Junctions
- Pollution Trap
- Subsoil Clean-Out pit
- Stormwater Jump ups
- Stormwater Main
- Connector: Reticulati
- Culvert Pipe; LinkSta
- Inter-Allotment
- Low Flow Pipe
- Other
- Stormwater Drop Structures
- Open Channel
- Batter Chute, Open L
- Drain
- Bio-Retention Swale
- Subsoil Drain
- Weirs
- Abandoned Junctions
- Abandoned Culverts
- Abandoned Headwalls
- Abandoned Mains
- Stormwater Basins
- Bio-Retention
- Detention/Retention
- Culverts Private
- Headwalls Private
- Stormwater Junctions Private
- Pollution Trap Private
- Subsoil Clean-Out pit Private
- Stormwater Jump Up Private
- Stormwater Main Private
- Open Channel Private
- Subsoil Drain Private
- Retention Basins Private
- Hydrants
- Water Valves
- Other Valve Type
- Gate, Sluice, Butterf
- Air Valve
- Ball Cock, Stop Cock
- Ball Valve
- Motor Sluice Valve
- Non Return Valve
- Pressure Reducing V
- RPZ Valve
- Reflux Valve
- Scour Valve
- Sluice Bypass Valve
- Tap
- Water Valve Function
- Open - Dialysis
- Closed - Zone
- Water Valve Op Status
- Valve Normally Oper
- Valve Normally Clos
- Water Mains
- Other Main Type
- Trunk Main
- Reticulation Main
- Sampling Points
- Abandoned Mains
- Private Water Hydrants
- Private Water Valves
- Private Water Mains
- Private Water Abandoned M
- Sewer Network Structures
- Pump Station
- Treatment Plant
- Sewer Access Chambers
- Access Chambers
- Roll Over
- Lamp Hole | Inspecti
- Overflow Chamber
- Sewer Valves
- Sewer Jump Ups
- Sewer Gravity Mains
- Overflow Main
- Combined Main
- Reticulation Main
- Trunk Main
- Sewer Rising Mains
- Sewer Access Chambers Abandoned
- Sewer Mains Abandoned
- Sewer Network Structures Pri
- Pump Station
- Treatment Plant
- Sewer Access Chambers Pri
- Sewer Joints Private
- Sewer Valves Private
- Sewer Gravity Mains Private
- Sewer Rising Mains Private
- Sewer Jump Ups Private
- Sewer Mains Abandoned Pri
- Sewer Access Chambers Abandoned Private
- Easements
- Property Parcels (Main)
- Roads1
- Main Roads
- Major Council Roads
- Standard Council Ro
- Access Roads
- Private Roads
- Unconstructed
- Ocean
- Rivers
- DCDB Parks
- National Park
- Reserves
- State Forest

Copyright protects this publication. Reproduction by whatever means is prohibited without prior written permission of the Chief Executive Officer, Rockhampton Regional Council. Rockhampton Regional Council will not be held liable under any circumstances in connection with or arising out of the use of this data nor does it warrant that the data is error free. Any queries should be directed to the Customer Service Centre, Rockhampton Regional Council or telephone 1300 22 55 77. The Digital Cadastral DataBase is current as at September 2022. © The State Government of Queensland (Department of Natural Resources and Mines) 2022. All other data © Rockhampton Regional Council 2022. This map is a user generated static output from an Internet mapping site and is for reference only. Data layers that appear on this map may or may not be accurate, current, or otherwise reliable.



**ROCKHAMPTON REGIONAL COUNCIL**  
**APPROVED PLANS**  
 These plans are approved subject to the current conditions of approval associated with  
**Development Permit No.: D/92-2022**  
**Dated: 1 November 2022**



# 127 East Street, Mount Morgan

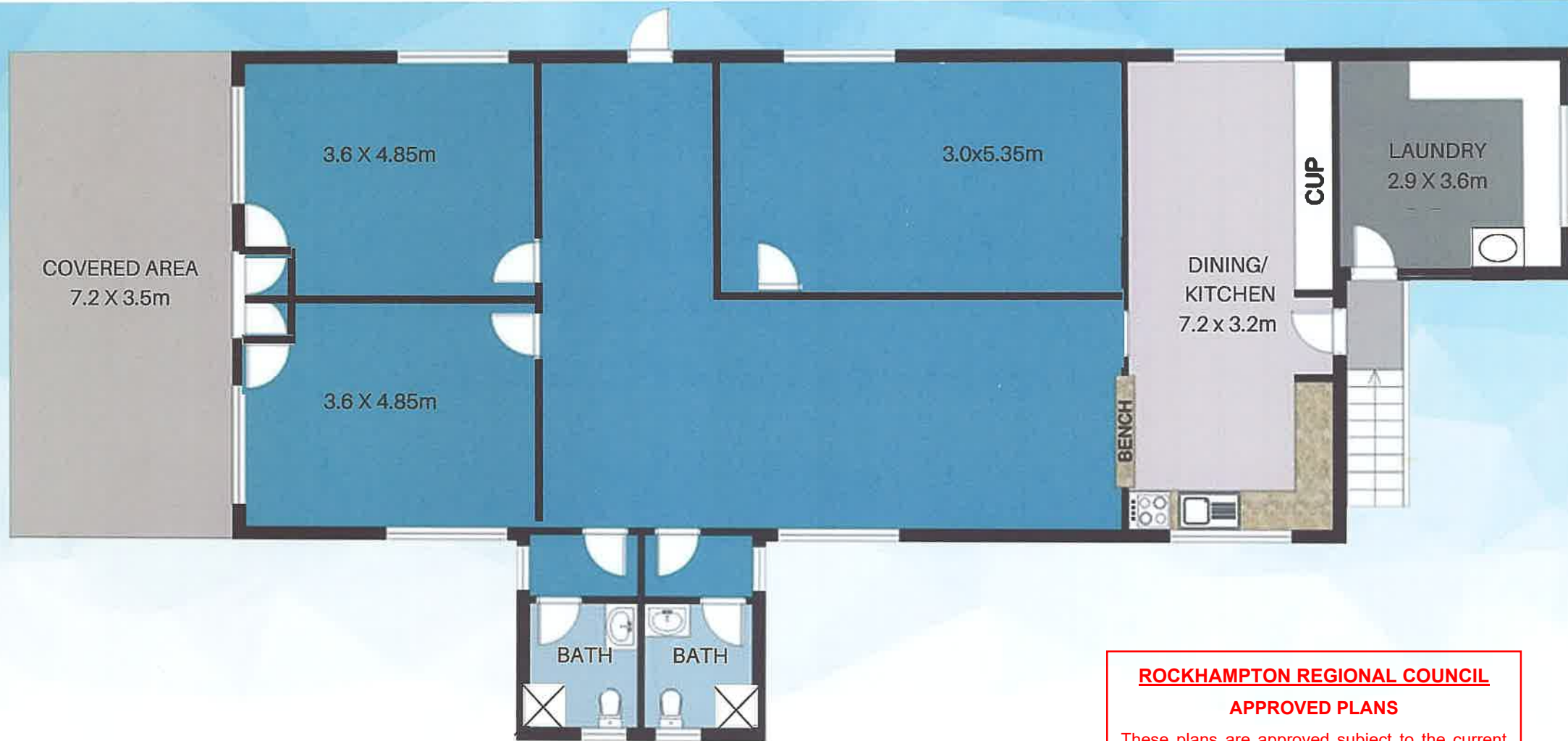

**ROCKHAMPTON REGIONAL COUNCIL**  
**APPROVED PLANS**

These plans are approved subject to the current conditions of approval associated with

**Development Permit No.: D/92-2022**

**Dated: 1 November 2022**