



### IMPORTANT NOTE

This plan was prepared to accompany an application to Rockhampton Regional Council and should not be used for any other purpose.

The dimensions and areas shown hereon are subject to field survey and also to the requirements of council and any other authority which may have requirements under any relevant legislation.

In particular, no reliance should be placed on the information on this plan for any financial dealings involving the land.

This note is an integral part of this plan.

client

C. Green

project

87 Bennett Street,  
Berserker

plan of  
**Reconfiguration Plan**  
(1 Lot into 2 Lots)  
(with Ortho Underlay)

rpd

Lot 1 on RP605137

lga  
Rockhampton Regional Council

issue	date	details	authorised
A	7-02-2019	Initial Issue	RJKF

created



scale  
**1:250 @ A3**  
sheet no.  
**1 of 1**  
plan no.  
**6793-06-ROL**

datum  
-  
cad file  
**6793-06-ROL-A**  
issue  
**A**

**ROCKHAMPTON REGIONAL COUNCIL**  
**APPROVED PLANS**  
These plans are approved subject to the current conditions of approval associated with  
**Development Permit No.: D/8-2019**  
**Dated: 22 February 2019**

PLANNING SCHEDULE			
Planning Statistics			
Zone	Low Density Residential Zone		
Applicable Primary Code	Low Density Residential Zone Code		
Applicable Sub-Codes	Acid Sulfate Soils Code Airport environs overlay code Self-assessable works code		
Site & Facility Statistics			
Site Area	632.00 m <sup>2</sup>		
Sewer	Served by Municipal Sewerage System		
Site Usage	Building Footprint	272.11m <sup>2</sup>	43.05%
	Driveway	42.41m <sup>2</sup>	6.71%
	Landscaping	317.48m <sup>2</sup>	50.24%
	TOTAL		100%
No. of onsite Carpark Required	4		
Provided	4		
Building Statistics			
No. of Stories	1		
Building Ground Floor Area	272.11m <sup>2</sup>		
Building Total Area	272.11m <sup>2</sup>		
Building Height			
Allowable	4.3m		
Proposed	4.3m		
Tenancy Nett Lattable Areas			
Unit 1	136.06m <sup>2</sup>		
Unit 2	136.06m <sup>2</sup>		
Setbacks (to main walls)	Building to Northern Alignment	5.28m	
	Building to Eastern Alignment	1.49m	
	Building to Southern Alignment	5.28m	
	Building to Western Alignment	1.50m	

#### RP Data

Lot Number : 1  
 RP/SP Number : RP605137  
 Parish : Archer  
 County : Livingstone  
 Area : 632m<sup>2</sup>

### ROCKHAMPTON REGIONAL COUNCIL

#### APPROVED PLANS

These plans are approved subject to the current conditions of approval associated with

**Development Permit No.: D/8-2019**

**Dated: 22 February 2019**

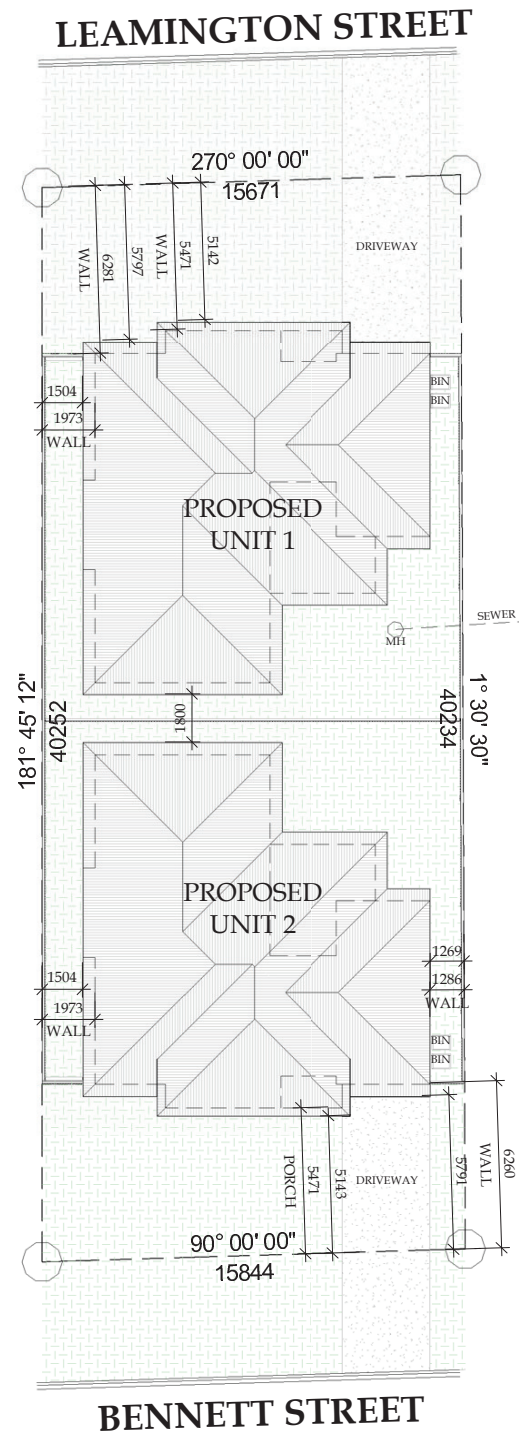

Copyright CAPRICORN ENGINEERING AND DRAFTING SERVICES.  
 All rights reserved. The information contained in this document is subject to the terms and conditions of the agreement or contract under which the document was supplied to the recipient's organisation. None of the information contained in this document and no part of this document shall be:  
 a) disclosed outside the recipient's own organisation  
 b) reproduced or transmitted in any way or stored in any retrieval system,  
 without the prior written permission of CAPRICORN ENGINEERING AND DRAFTING SERVICES.

SUF	REVISIONS	DATE	INIT
1	Conceptual	06.02.17	TJE
2	Client Amend	20.03.17	TJE
3	DA Issue	04.05.17	TJE
4	Construction	15.06.17	LC
5	Client Amend	14.08.17	LC



PROPOSED  
 2 Units For Craig & Rachel  
 Green

ADDRESS  
 87 Bennett Street, Berserker

DRAWING  
 Site Plan

**CEADS** CAPRICORN ENGINEERING AND DRAFTING SERVICES  
 PO Box 1734, Yeppoon, QLD, 4703  
 PH: (07) 49250772 Fax: (07) 49395808 Email: info@ceads.com.au

BSA - 1125594  
 www.ceads.com.au

DATE:  
 15.06.17

DRAWN BY:  
 TJE

CHECKED BY:  
 TJE

SCALE:  
 As indicated

PROJECT STATUS:  
 Construction

DWG No. 17-033-C SHT No. 001 REV 5