

1170 Mercure HOTEL

This design has been produced by and is the sole and exclusive property of SIGNSPEC AUSTRALIA. A.C.N. 09872823 who reserves all rights of reproduction and construction in any form whatsoever and to whom this design must be referred forthwith upon demand. The receipt by you of this design shall be evidence of your acceptance of these conditions. © copyright as above.

Mercure

DESCRIPTION
 ACCOR-MERCURE HOTEL
 ROCKHAMPTON

JOB NO. 133736/133629

A3 DO NOT SCALE

CONSTRUCTION DRAWING REFERENCES
 NO CONST. DWG REF.

DRAWING TYPE PRELIMINARY

CLIENT SPECIFIC SPECS

- DIGITALLY PRINTED PERFORATED FINISH
- AUBERGINE PMS 7664C
- BRONZE PMS 4505

Please note that original source file colour shifts may occur through software and printer setting interference. The colour representation shown in this artwork may not visually represent the nominated colour. It is the customer's responsibility to check and nominate colour reference for accuracy.

GENERAL NOTES

Internal Illumination
 Digitally printed (PMS 7664c) perforated finish to allow for 'near opal' night illumination.
 Individual 125mm deep 'Permasign' letters
 Opaque returns & illuminated faces.
 Colours : Corporate Colours
 Quantity : 1 off
 Face illuminated 125mm 'Permasign' letters.
 On aluminium rails - colour TBC.

ROCKHAMPTON REGIONAL COUNCIL
APPROVED PLANS
 These plans are approved subject to the current conditions of approval associated with
Development Permit No.: D52/2020
Dated: 18 June 2020

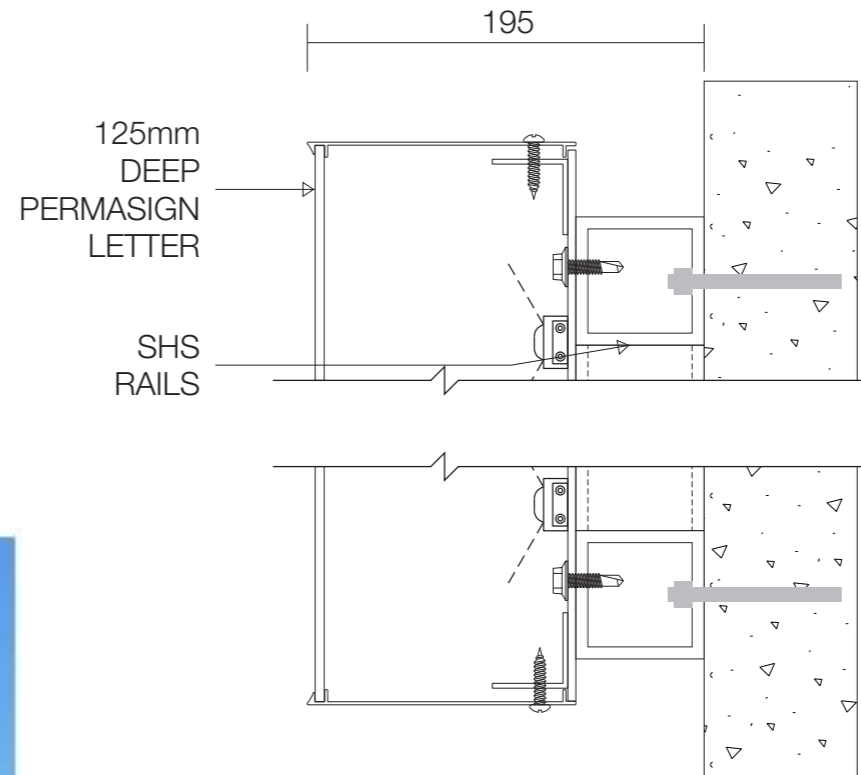

ILLUMINATED
 MERCURE
 HOTEL SIGN
 12.9m x 1.17m



Ø	ORIGINAL ISSUE	SEB	XX	10.06.20
REV.	AMENDMENTS	DWN	CKD	DATE
DRAWING NUMBER				ISSUE
MERCU00019-04				Ø