

**ROCKHAMPTON REGIONAL COUNCIL**  
**APPROVED PLANS**  
These plans are approved subject to the current conditions of approval associated with  
**Development Permit No.: D/44-2020**  
**Dated: 10 September 2020**

drawing title:  
**LOCATION PLAN**

drawing no: **SK-001** project no: **RR-014**

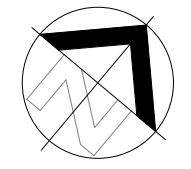

project: <b>GRACEMERE CEMETERY</b>	
location: GRACEMERE	client: ROCKHAMPTON REGIONAL COUNCIL

REV	DESCRIPTION	DATE
4	PRELIMINARY	10/7/2019
5	PRELIMINARY	08/04/2020
6	PRELIMINARY	09/04/2020

**PRELIMINARY SKETCH PLANS:**  
If the drawings are labelled and issued 'preliminary', below, they are not suitable for Building Application, tender or construction purposes!  
The intent of preliminary sketch plans are only for presenting the concept for the specific project to the client as nominated in the title sheet.

**COPYRIGHT & LIABILITY:**  
These drawings, concepts and designs are copyrighted and the property of DESIGNANDARCHITECTURE and not to be used for any other reason without the consent or permission of designandarchitecture PTY.LTD. (ACN 167 978 832)

DESIGNANDARCHITECTURE accept no responsibility for the accuracy, completeness of electronically transferred documents.

NEVER SCALE OF DRAWINGS, IF IN DOUBT, ASK!



design + architecture  
abn: 80167978832 Pty.Ltd.

044 968 2924  
www.designaa.com.au

design@designaa.com.au  
reg no:4610

ISSUED FOR <b>PRELIMINARY</b>	
scale 1 : 2500	rev
date APR 20	<b>6</b>
drawn CC	



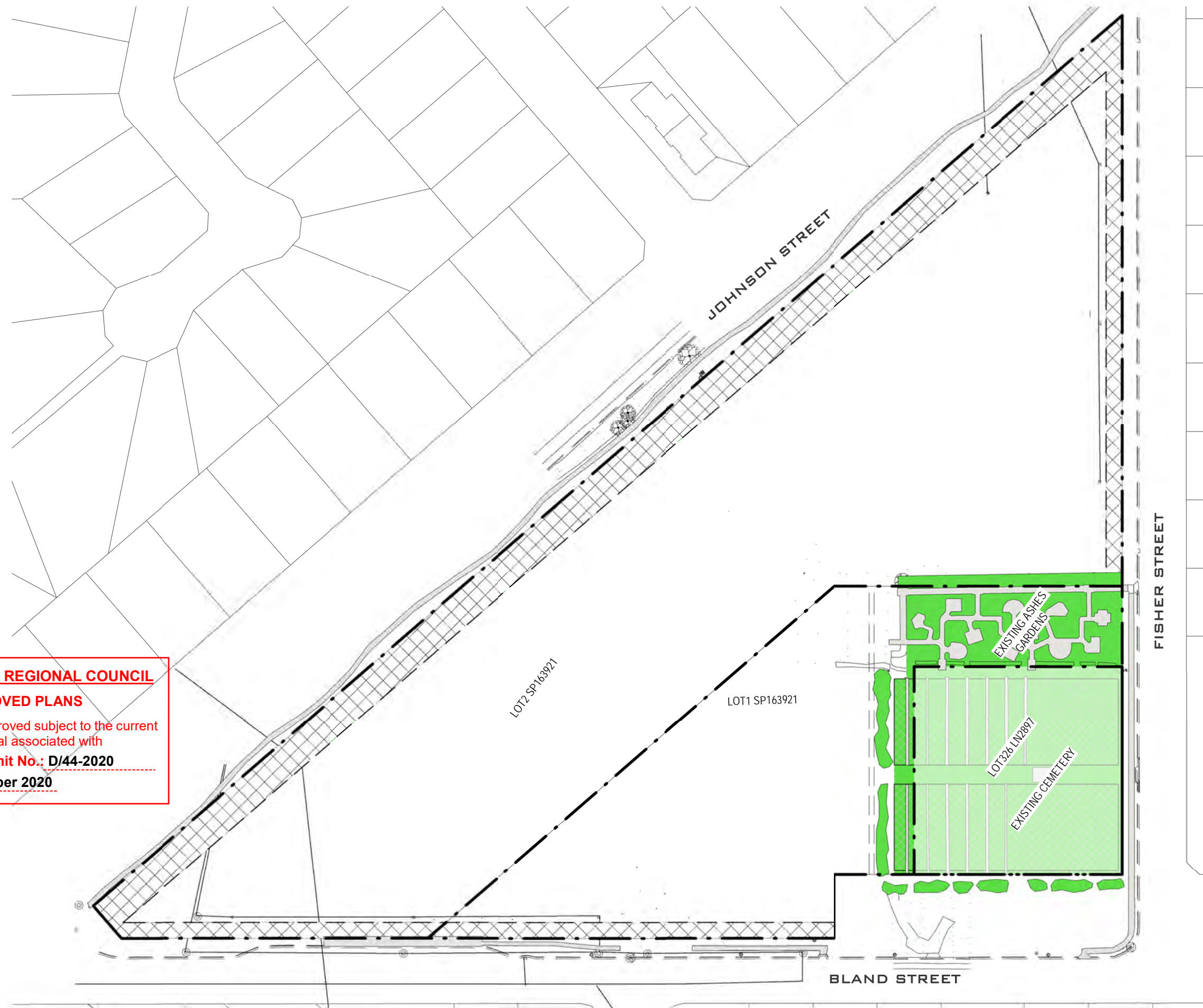

# ROCKHAMPTON REGIONAL COUNCIL

## APPROVED PLANS

These plans are approved subject to the current conditions of approval associated with

**Development Permit No.:** D/44-2020

**Dated:** 10 September 2020

drawing title:  
**OVERALL EXISTING**

drawing no: **SK-002** project no: **RR-014**

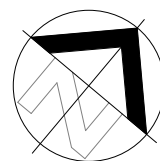

project: <b>GRACEMERE CEMETERY</b>	
location: GRACEMERE	client: ROCKHAMPTON REGIONAL COUNCIL

REV	DESCRIPTION	DATE
4	PRELIMINARY	10/7/2019
5	PRELIMINARY	08/04/2020
6	PRELIMINARY	09/04/2020

**PRELIMINARY SKETCH PLANS:**  
If the drawings are labelled and issued 'preliminary', below, they are not suitable for Building Application, tender or construction purposes!  
The intent of preliminary sketch plans are only for presenting the concept for the specific project to the client as nominated in the title sheet.

**COPYRIGHT & LIABILITY:**  
These drawings, concepts and designs are copyrighted and the property of DESIGNANDARCHITECTURE and not to be used for any other reason without the consent or permission of designandarchitecture PTY.LTD. (ACN 167 978 832)

DESIGNANDARCHITECTURE accept no responsibility for the accuracy, completeness of electronically transferred documents.

NEVER SCALE OF DRAWINGS, IF IN DOUBT, ASK!



ISSUED FOR <b>PRELIMINARY</b>	
scale 1 : 1250	rev
date APR 20	6
drawn Author	



**ROCKHAMPTON REGIONAL COUNCIL**  
**APPROVED PLANS**  
These plans are approved subject to the current conditions of approval associated with  
**Development Permit No.: D/44-2020**  
**Dated: 10 September 2020**

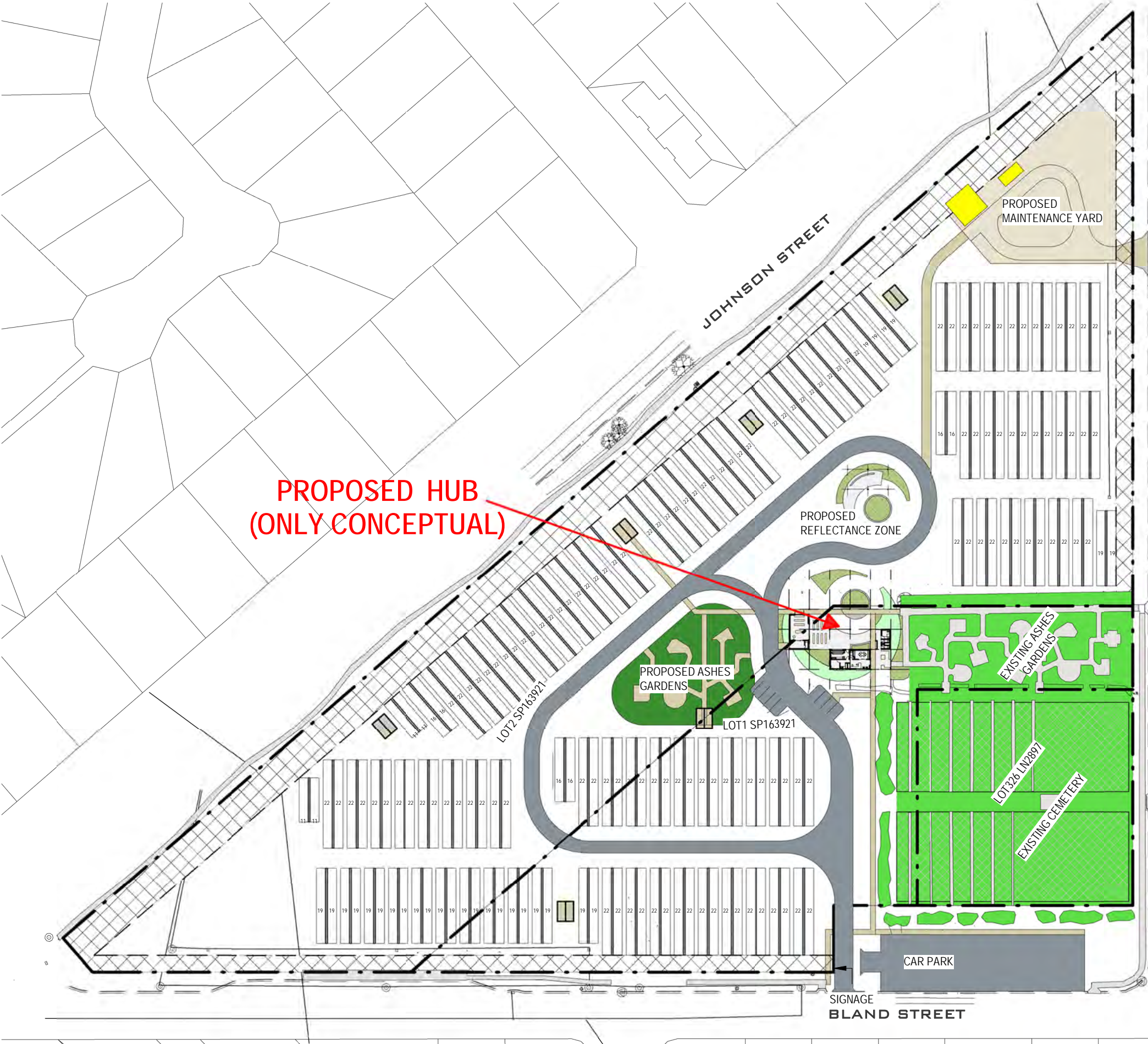

drawing title:  
**OVERALL MASTER PLAN**

drawing no: **SK-003** project no: **RR-014**

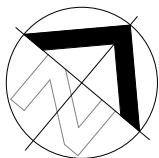

project: <b>GRACEMERE CEMETERY</b>	
location: GRACEMERE	client: ROCKHAMPTON REGIONAL COUNCIL

REV	DESCRIPTION	DATE
4	PRELIMINARY	10/7/2019
5	PRELIMINARY	08/04/2020
6	PRELIMINARY	09/04/2020

**PRELIMINARY SKETCH PLANS:**  
If the drawings are labelled and issued 'preliminary', below, they are not suitable for Building Application, tender or construction purposes!  
The intent of preliminary sketch plans are only for presenting the concept for the specific project to the client as nominated in the title sheet.

**COPYRIGHT & LIABILITY:**  
These drawings, concepts and designs are copyrighted and the property of DESIGNANDARCHITECTURE and not to be used for any other reason without the consent or permission of designandarchitecture PTY.LTD. (ACN 167 978 832)

DESIGNANDARCHITECTURE accept no responsibility for the accuracy, completeness of electronically transferred documents.

NEVER SCALE OF DRAWINGS, IF IN DOUBT, ASK!



design + architecture  
abn: 80167978832 Pty.Ltd.

044 968 2924  
www.designaa.com.au

design@designaa.com.au  
reg no:4610

ISSUED FOR <b>PRELIMINARY</b>	
scale 1 : 1250	rev
date <b>APR 20</b>	<b>6</b>
drawn <b>Author</b>	





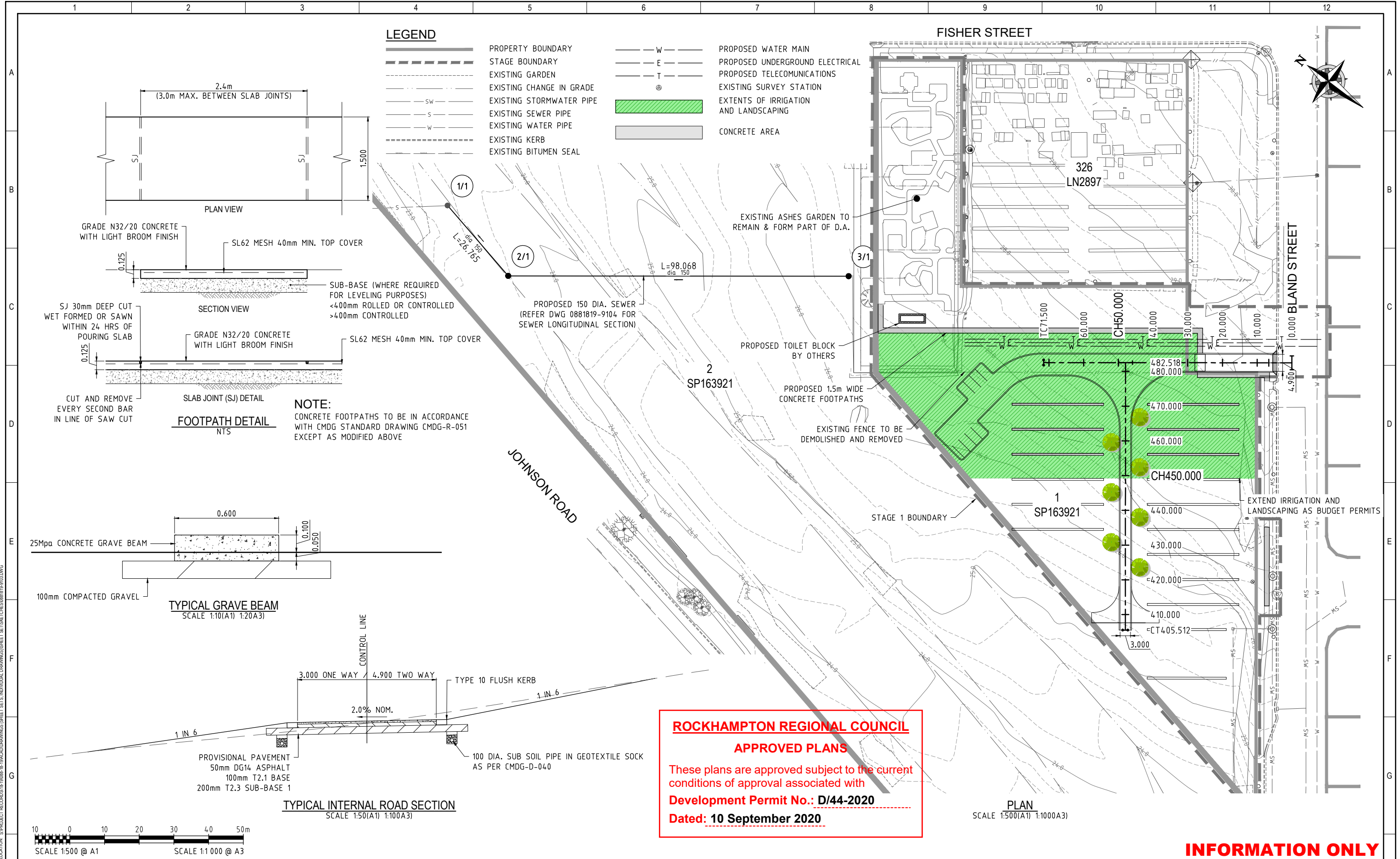

**ROCKHAMPTON REGIONAL COUNCIL**  
**APPROVED PLANS**  
These plans are approved subject to the current conditions of approval associated with **Development Permit No.: D/44-2020**  
**Dated: 10 September 2020**

**INFORMATION ONLY**

SURVEYOR			BY			DATE			CLIENT			PREPARED BY			CLIENT		
ROCKHAMPTON REGIONAL COUNCIL			REVIEWED						Rockhampton Regional Council			mcmurtrie CONSULTING ENGINEERS			ROCKHAMPTON REGIONAL COUNCIL		
ADDRESS:			RPEQ ENG						NOTE: THIS DRAWING IS SOLELY THE PROPERTY OF MCMURTRIE CONSULTING ENGINEERS PTY LTD. THE INFORMATION CONTAINED IS NOT TO BE DISCLOSED, REPRODUCED OR COPIED IN WHOLE OR PART WITHOUT WRITTEN APPROVAL FROM MCMURTRIE CONSULTING ENGINEERS PTY LTD.			Address: 63 Charles Street			PROJECT		
CO-ORDINATE DATUM			RPEQ No:			SCALE: AS SHOWN			McMurtrie & Associates Pty Ltd			Address: 63 Charles Street			TITLE		
MGAS6												North Rockhampton QLD 4701			STAGE 1 - LAYOUT AND TYPICAL SECTION		
HEIGHT DATUM												PO BOX 2149, WANDAL QLD 4700			DRAWING NUMBER		
AHD												E-mail: mail@mcmurtrie.com			A1 0881819-9103		
															REVISION		
															B		