



Department of  
**State Development,  
Infrastructure and Planning**

Our reference: SDA-0115-017447

Your reference: D/299-2014

29 January 2015

The Chief Executive Officer  
Rockhampton Regional Council  
[enquiries@rrc.qld.gov.au](mailto:enquiries@rrc.qld.gov.au)

Attention Petrus Barry

Dear Sir/Madam,

**Concurrence agency response - no requirements**

137-151 Farm Street, Kawana (Lot 100 on SP259326)

(Given under section 285 of the *Sustainable Planning Act 2009*)

The referral agency material for the development application described below was received by the Department of State Development, Infrastructure and Planning under section 272 of the *Sustainable Planning Act 2009* on 14 January 2015.

**Applicant details**

---

Applicant name:	The Presbyterian Church of Queensland C/- Adams + Sparkes Town Planning + Development
Applicant contact details:	PO Box 455 Rockhampton QLD 4700

**Site details**

---

Street address:	137-151 Farm Street, Kawana QLD 4701
Real property description:	100 SP259326

Local government area: Rockhampton Regional

### Application details

Proposed development: Development Permit for Material Change of Use (Aged Care Accommodation)

### Referral triggers

The development application was referred to the department under the following provisions of the Sustainable Planning Regulation 2009:

Referral trigger Schedule 7, Table 3, Item 2— State Transport Infrastructure

### No requirements

The department advises the assessment manager, under section 287(2)(a) of the *Sustainable Planning Act 2009*, that it has no requirements relating to the application.

### Further advice

Under section 287(6) of the *Sustainable Planning Act 2009*, the department offers the following advice about the application to the assessment manager:

General advice	
1.	It is recommended to the assessment manager that the following plans and specifications be included in the Decision Notice: <ul style="list-style-type: none"> <li>- 'Proposed Site Plan', prepared by Thomson Adsett, dated 04-12-2014, reference number 14.0234.</li> </ul>

A copy of this response has been sent to the applicant for their information.

If you require any further information, please contact Carl Porter, Senior Planning Officer, on 07 4924 2917 or via email at [RockhamptonSARA@dsdip.qld.gov.au](mailto:RockhamptonSARA@dsdip.qld.gov.au) who will be pleased to assist.

Yours sincerely



Anthony Walsh  
A/Manager Planning  
Fitzroy and Central

cc: The Presbyterian Church of Queensland C/- Adams & Sparkes, [pete@astpd.com.au](mailto:pete@astpd.com.au)

ALEXANDRA STREET

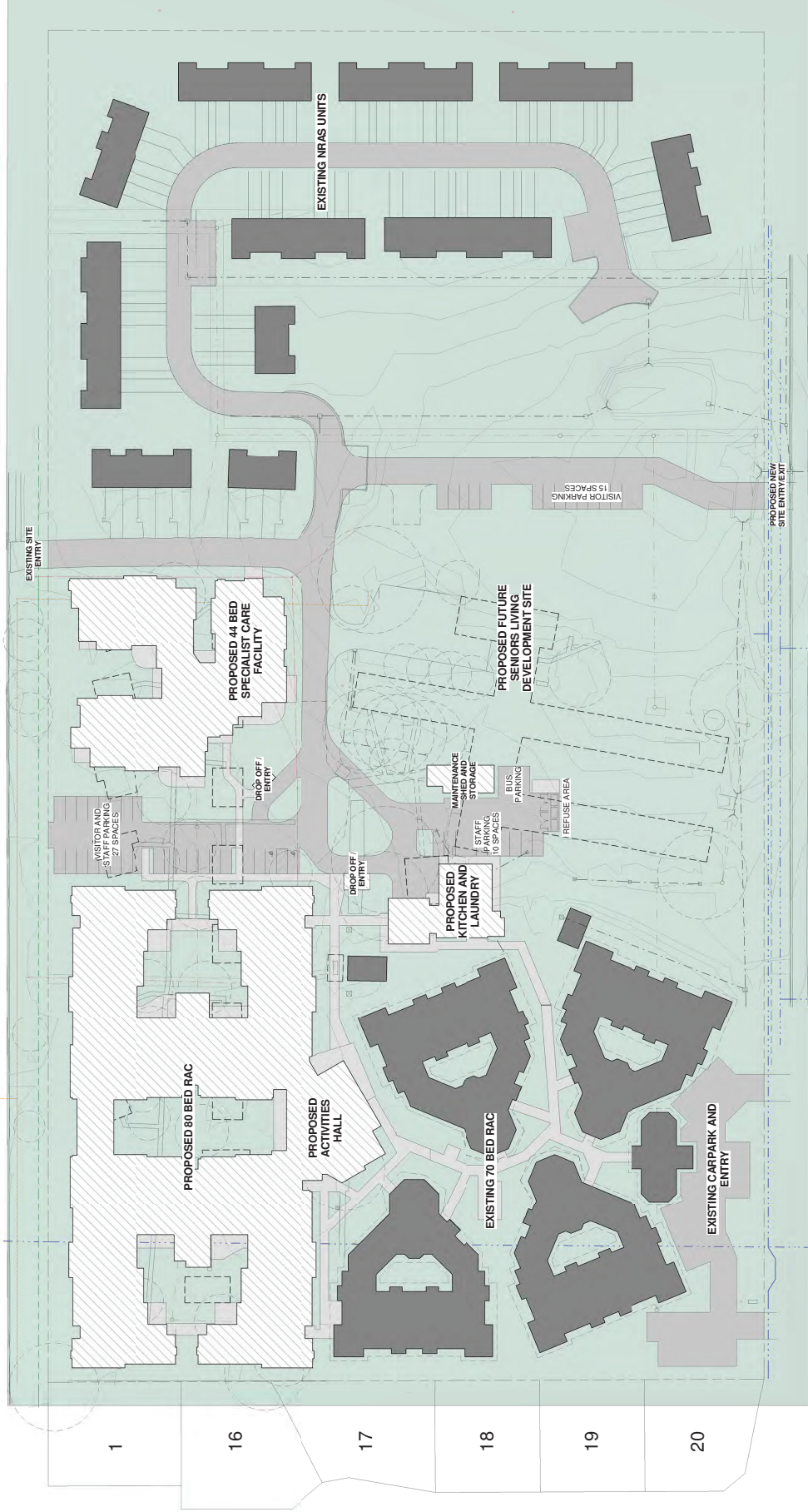

DEVELOPMENT SUMMARY	
TOTAL SITE AREA	48.84sqm
EXISTING BUILDINGS	
EXISTING 70 BED RAC (BEDS)	1,207sqm
EXISTING 44 BED SPECIALIST CARE FACILITY (BEDS)	1,600sqm
EXISTING 80 BED RAC FACILITY	3,010sqm
TOTAL	5,817sqm
PROPOSED BUILDINGS	
PROPOSED 80 BED FACILITY	4,231sqm
COVERED OUTDOOR	244sqm
ACTIVITIES HALL	40sqm
44 BED SPECIAL CARE FACILITY	1,519sqm
COVERED OUTDOOR	130sqm
COVERED OUTDOOR	1,010sqm
COVERED OUTDOOR	332sqm
KITCHEN/LAUNDRY	40sqm
PROPOSED SENIORS LIVING	8,177sqm
TOTAL NEW BUILDINGS	52
TOTAL NEW BUILDINGS	15,114sqm (AFTER DEMOLITION OF EXISTING)
TOTAL BUILDING AREA	14,144sqm



ThomsonAdsett accept no responsibility for the usability, completeness or accuracy of data transferred electronically. Users should ensure that data is correct and that they have verified the data before using it for any purpose. Use of the data is at the user's own risk.

© Copyright  
These drawings are the property of ThomsonAdsett Pty Ltd and may not be reproduced or copied without the written permission of ThomsonAdsett Pty Ltd. All rights reserved. A.B.N. 78 103 314 853. Trading as ThomsonAdsett.



Level 1, 220 Quay St.  
Rockhampton  
PO Box 1479  
Rockhampton Q 4700  
Email: [info@thomsonadsett.com](mailto:info@thomsonadsett.com)  
www.thomsonadsett.com

PROPOSED SITE DEVELOPMENT

PRES-CARE  
ALEXANDRA GARDENS  
NORTH ROCKHAMPTON

WOOLLAM CONSTRUCTIONS

PROPOSED SITE PLAN

DATE	04.12.2014
SCALE	1:500
DRAWN	SMP
CHECKED	SMP
VERIFIED	SMP
PROJECT NO.	SD 001
SHEET NO.	14.0234