

These plans are approved subject to the current conditions of approval associated with

Preliminary Approval No.: D/169-2021

Dated: 25 January 2022

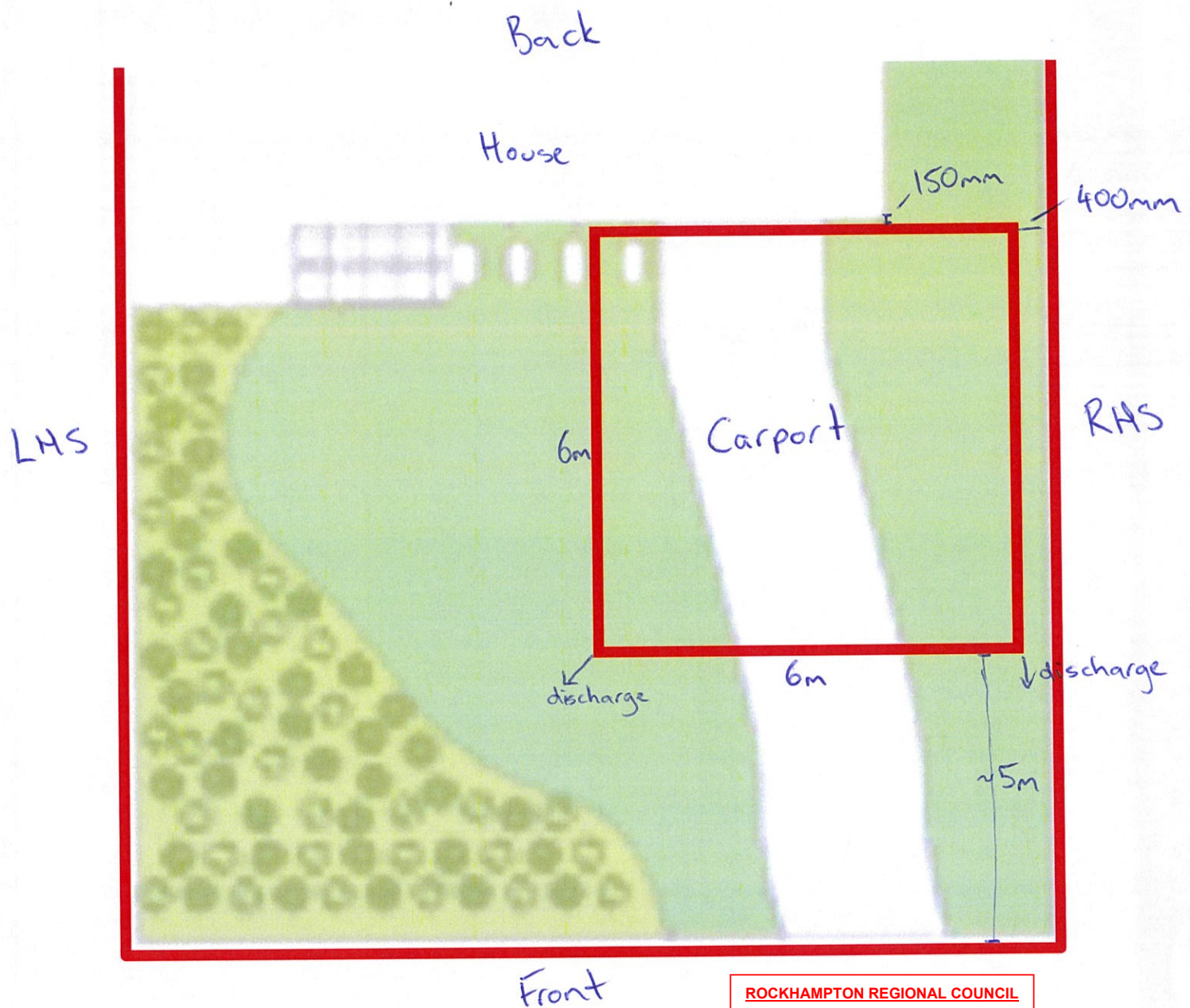



ROCKHAMPTON REGIONAL COUNCIL

APPROVED PLANS

These plans are approved subject to the current conditions of approval associated with

Preliminary Approval No.: D/169-2021

Dated: 25 January 2022

Carport

- 150mm from house
- 400mm from RHS boundary
- ~5000mm from Front boundary
- 6600mm from LHS boundary

House

- 400mm from LHS boundary
- 2600mm from RHS boundary
- ~11000mm from front boundary

Carport approximately 4000mm from RHS adjacent property dwelling.

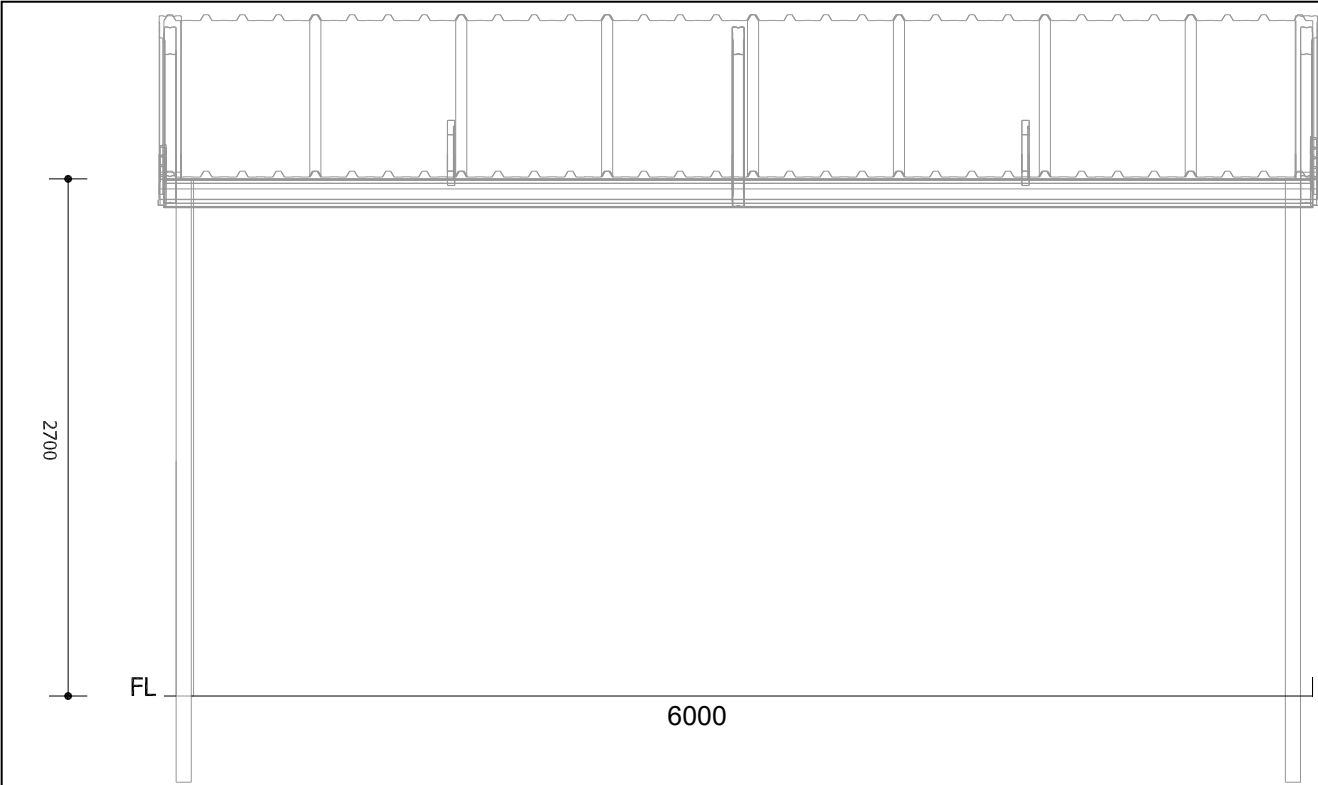

Elevation 1

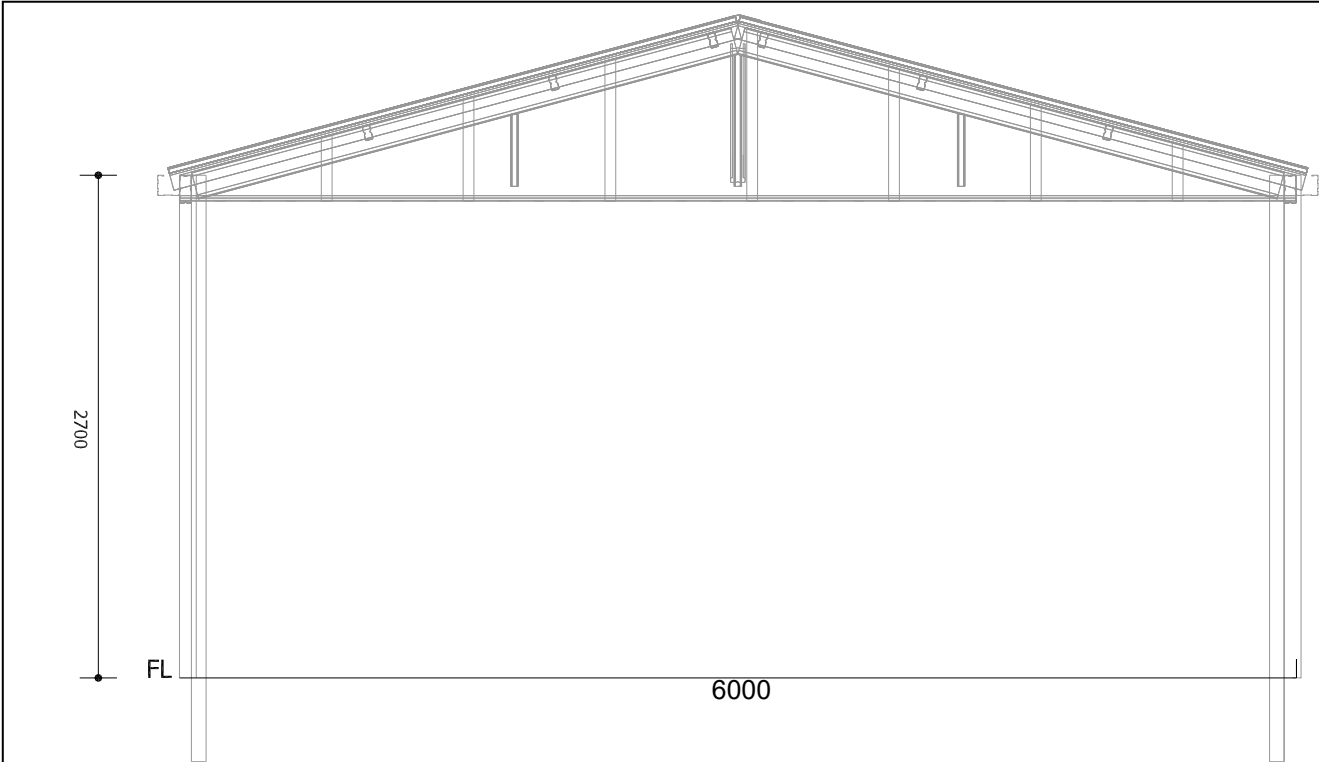

Elevation 2

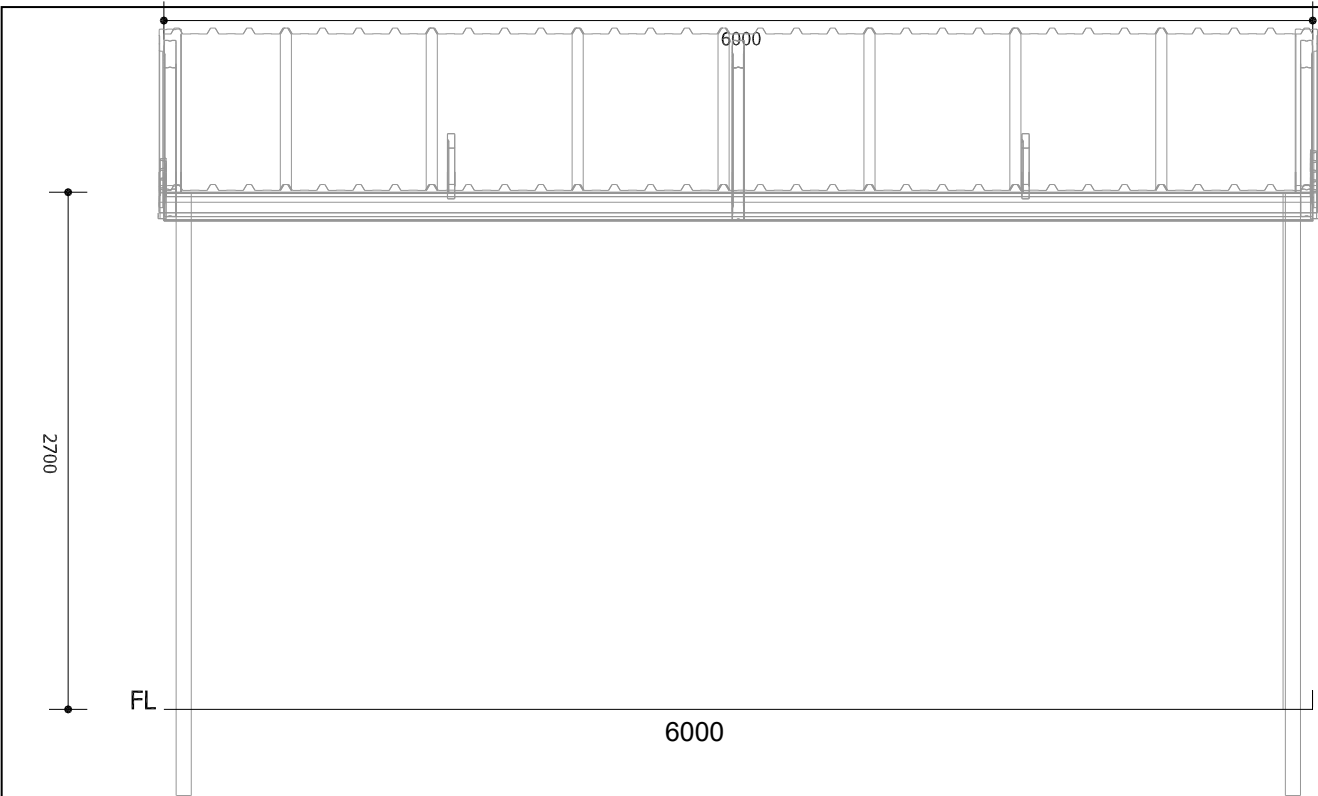

Elevation 3

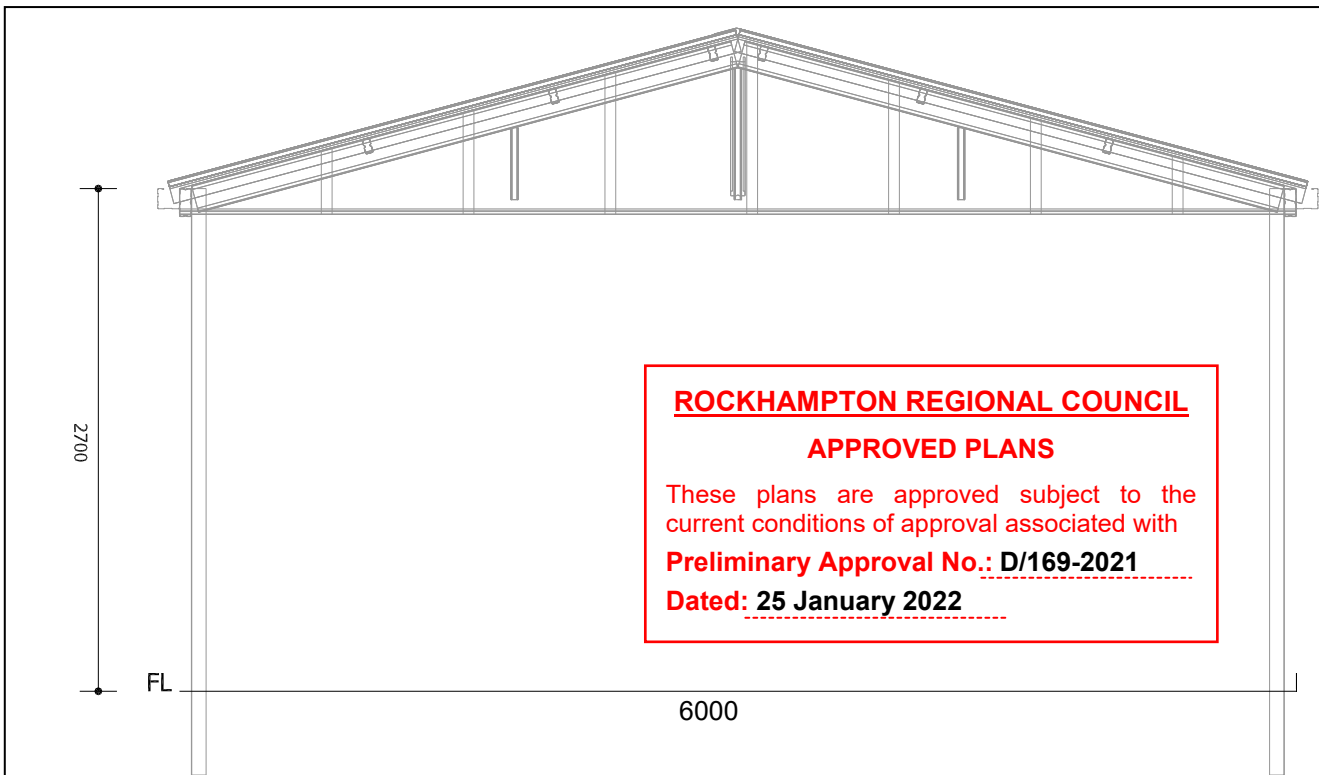

Elevation 4

ROCKHAMPTON REGIONAL COUNCIL

APPROVED PLANS

These plans are approved subject to the current conditions of approval associated with

Preliminary Approval No.: D/169-2021

Dated: 25 January 2022

I certify that buildings erected in accordance with these drawings will comply with the Building Code of Australia.

Wirtu L. Bayissa

B.Sc (Civil), M.Tech (Building/Services), PhD (Structures),
MIE Aust (2853082), RPEng (881707), RPEQ (16592), RBP Vic (PE0002085), AC
(NSW) (BDC3146), BSP (Tas) (702601568)

Signed.....

Date:

18-11-2021



For: Lachlan Mckenzie

Project No: SSA1875

Date: 5/11/2021 1:19:59 PM

Framing plans

Elevation page

3 of 12