

ROCKHAMPTON REGIONAL COUNCIL

APPROVED PLANS

These plans are approved subject to the current conditions of approval associated with

Development Permit No.: D/114-2018

Dated: 30 November 2018

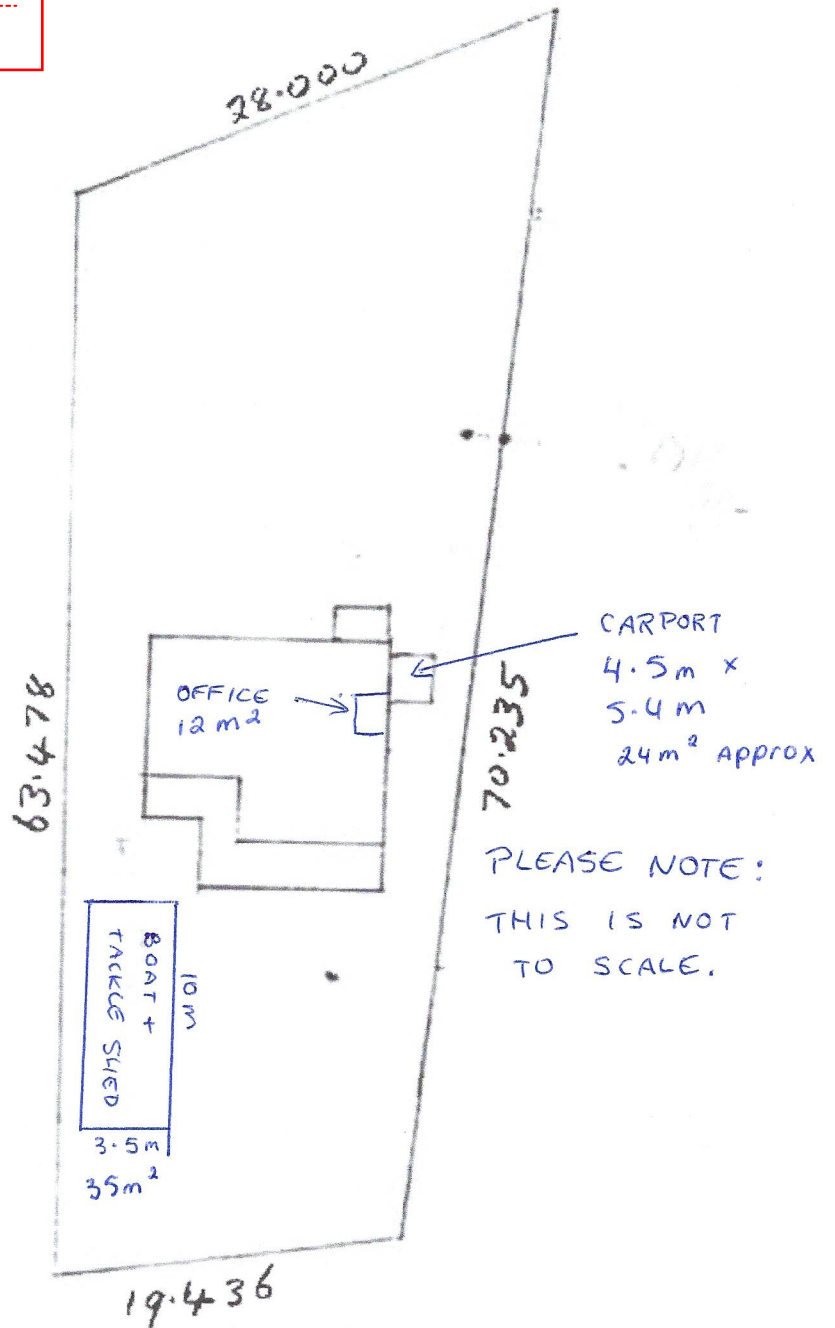

N RP 16426
SHER
VINGSTONE
m²

SITE PLAN

STO BE 450 M.M.
HOUSE CONNECTION

not 26/90/90