

145° 00' 00"  
33,800 m

W 01 E 09  
235° 08' 00"



**R.P.D.**  
 Lot Number : 12  
 Reg./Survey Plan Number : SP 254680  
 Parish : MURCHISON  
 County : LIVINGSTONE  
 Area : 2041.0 sqm

**SITE NOTES**  
**GENERAL**  
 SITE LEVELS AND FINISHED FLOOR LEVELS ARE TO BE VERIFIED BY THE BUILDER BEFORE STARTING WORK.  
 ALL CUT & FILLED EARTH EMBANKMENTS ARE TO BE GRASSED UNLESS NOTED OTHERWISE.  
**SITE DRAINAGE**  
 FOR LEVEL SITES FALL GROUND AWAY FROM BUILDING 50mm IN A MINIMUM DISTANCE OF 1m ON ALL SIDES.  
 PROVIDE FALLS TO FINISH GROUND SURFACE TO PREVENT WATER PONDING AT ANY POINT IN THE VICINITY OF THE BUILDING OR ON THE COMMON BOUNDARY OF ADJOINING ALLOTMENTS.  
**ROOF DRAINAGE**  
 DISCHARGE DOWN PIPES TO K, AND C  
**WASTE DISPOSAL**  
 DISCHARGE WASTE WATER TO COUNCIL SEWER  
 HG  
 † - Hose cock

**ROCKHAMPTON REGIONAL COUNCIL**  
**APPROVED PLANS**  
 These plans are approved subject to the current conditions of approval associated with  
**Development Permit No.:** D/111-2023  
**Dated:** 15 February 2024

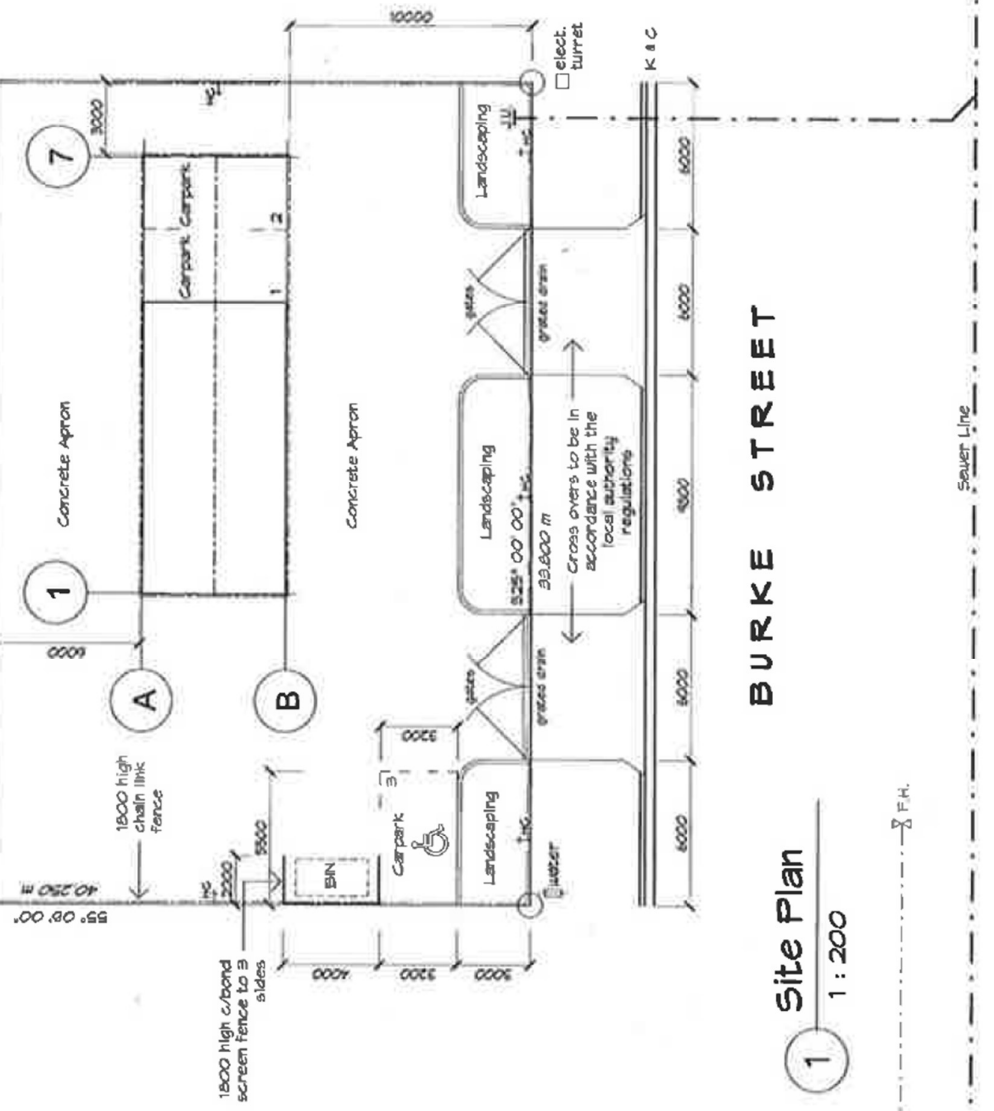

**BURKE STREET**

**Site Plan**  
 1 : 200

NO.	DESCRIPTION	DATE
A	DEVELOPMENT APPLICATION	25/11/20

**PROPOSED LT. INDUST. SHED  
 FOR G. & C. ADAMS  
 AT LOT 12 BURKE STREET,  
 PARKHURST**

**Rufus**  
 DESIGN GROUP  
 STYLE • QUALITY • INNOVATION

MEMBER  
 BUILDING DESIGNERS  
 ASSOC. OF QLD INC.

Licensed under  
 the QBSA Act  
 Lic No. 1180266

Telephone 61 7 49288011  
 Facsimile 61 7 49288579  
 E-mail mailbox@rufusdesigngroup.com

DESIGNED : <i>DAW</i>	WIND SPEED : C2	PROJECT NUMBER : 101118 - 01
DRAWN : <i>ILV</i>	PLAN SIZE : A3	SHEET 01 OF 09 SHEETS
CHKD : <i>JKP</i>	REVIT FILE : 101118.rvt	REV. A
SCALE : AS INDICATED		

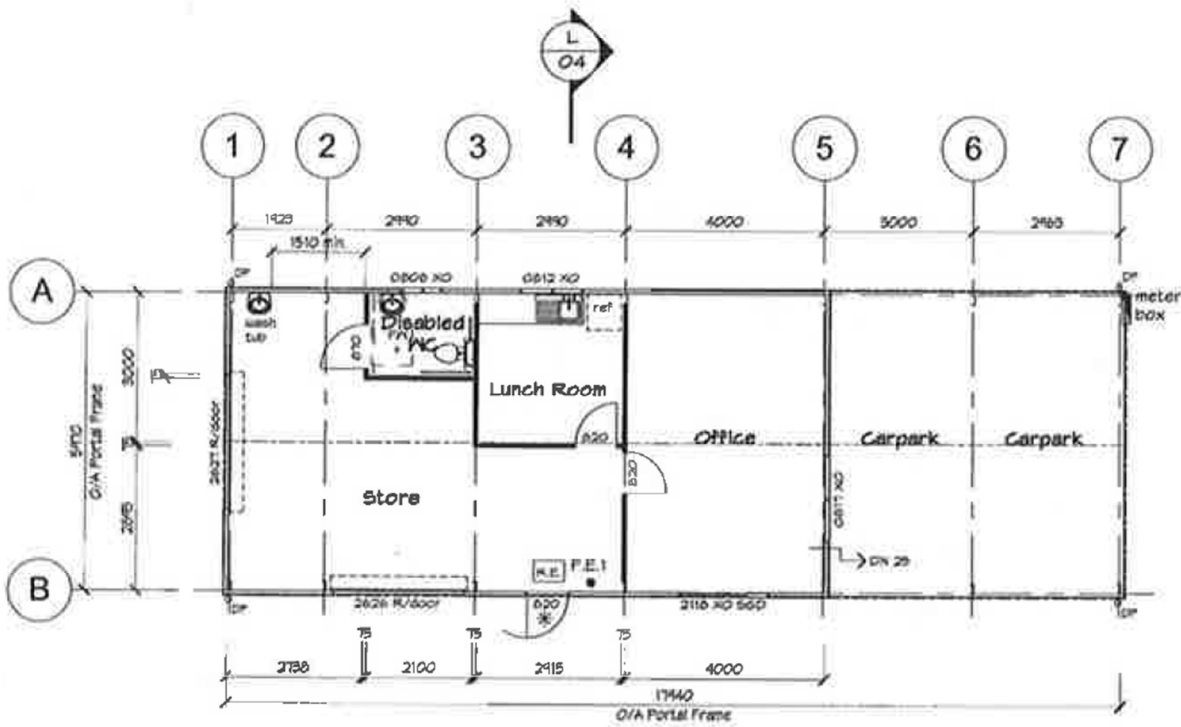

1 Floor Plan  
1:100

**ROCKHAMPTON REGIONAL COUNCIL**  
**APPROVED PLANS**

These plans are approved subject to the current conditions of approval associated with  
**Development Permit No.: D/111-2023**  
**Dated: 15 February 2024**

REVISIONS		
No.	DESCRIPTION	DATE
A	DEVELOPMENT APPLICATION	25/11/10

### Fire Safety Equipment

- [R.E.]** - Required Exit
- \* - Exit doors to be fitted with lever action escape latches
- Fire Extinguishers**
- F.E.1** 9kg water fire extinguisher (rating: 2A)

**THRESHOLDS :**  
TO BE IN ACCORDANCE WITH AS 1428.1, "ACCESS FOR THE DISABLED" (MAX. STEP 5mm, MAX. SLOPE 1 IN 8 FOR UP TO 192mm RISE).

### Other Consultants

**GEOTECHNICAL ENGINEER**  
Roadtest  
PH : 4925 0044 Fax : 4926 1256  
Scope of work : Soil test and site levels

**SHED SUPPLIER**  
Rebuild  
PH : (07) 4921 7777  
Scope of work : All shed structurals

### Floor Plan Legend

- DP - 90mm PVC down pipe
- FW + - Floor waste

**PROPOSED LT. INDUST. SHED**  
**FOR G. & C. ADAMS**  
**AT LOT 12 BURKE STREET,**  
**PARKHURST**



**MEMBER**  
BUILDING DESIGNERS  
ASSOC. OF QLD INC.

Licensed under  
the QBSA Act  
Lic No. 1180286

Telephone 61 7 49288011  
Facsimile 61 7 49266579

E-mail mailbox@rufusdesigngroup.com

DESIGNED : DJW	WIND SPEED : C2	PROJECT NUMBER : 101118 - 02
DRAWN : ILV	PLAN SIZE : A3	SHEET 02 OF 05 SHEETS
CHKD : DJW	REVIT FILE : 101118.rvt	REV. A
SCALE : 1:100		





**ROCKHAMPTON REGIONAL COUNCIL**  
**APPROVED PLANS**  
These plans are approved subject to the current conditions of approval associated with  
**Development Permit No.: D/111-2023**  
**Dated: 15 February 2024**

ISO A1 594mm x 841mm

FILENAME: R:\23-24\RCR02-23-24 - Civil Minor Jobs (under \$5000)\015 - 12 Burke St\Design\DWG\12 Burke Street.dwg

PLOT DATE: 2/2/2024 9:23:14 AM

**PROJECT STAMP**

**FOR INFORMATION**

**DRAWING SCALE**

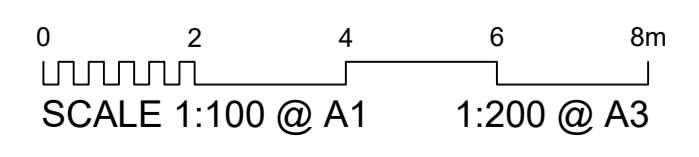

**ISSUE REVISION**

ISSUE	REV	DATE	DES	DESCRIPTION
INFO	A	01/12/23	N.M.	ISSUED FOR INFORMATION
INFO	B	01/12/23	N.M.	ISSUED FOR INFORMATION
INFO	C	02/02/24	N.M.	ISSUED FOR INFORMATION

**PROJECT MANAGEMENT**

THIS DOCUMENT IS UNCONTROLLED AND IS NOT TO BE USED

RPEQ CERTIFICATION		
N.M.	C.H.	
DESIGNER	CHECKED	APPROVED
INTERNAL PROJECT NO. RCB075-23-24		
DATUM	SURVEY	



ROCKHAMPTON | BUNDABERG  
PH (07) 4921 1780 | [mail@mcmengineers.com](mailto:mail@mcmengineers.com) | [MCMENGINEERS.COM](http://MCMENGINEERS.COM)

**PROJECT IDENTIFIER**

CLIENT	GIDEON TOWN PLANNING
PROJECT	12 BURKE STREET
TITLE	BUS SWEEP PATHS
DRAWING NUMBER	RCB0752324 / 001
REVISION	B

NOTE: THIS DRAWING IS SOLELY THE PROPERTY OF MCMURTRIE CONSULTING ENGINEERS PTY LTD. THE INFORMATION CONTAINED IS NOT TO BE DISCLOSED, REPRODUCED OR COPIED IN WHOLE OR PART WITHOUT WRITTEN APPROVAL FROM MCMURTRIE CONSULTING ENGINEERS PTY LTD.