

ROCKHAMPTON REGIONAL COUNCIL

These plans are approved subject to the current conditions of approval associated with Development Permit No. D/104-2017
 Dated: 26 October 2017

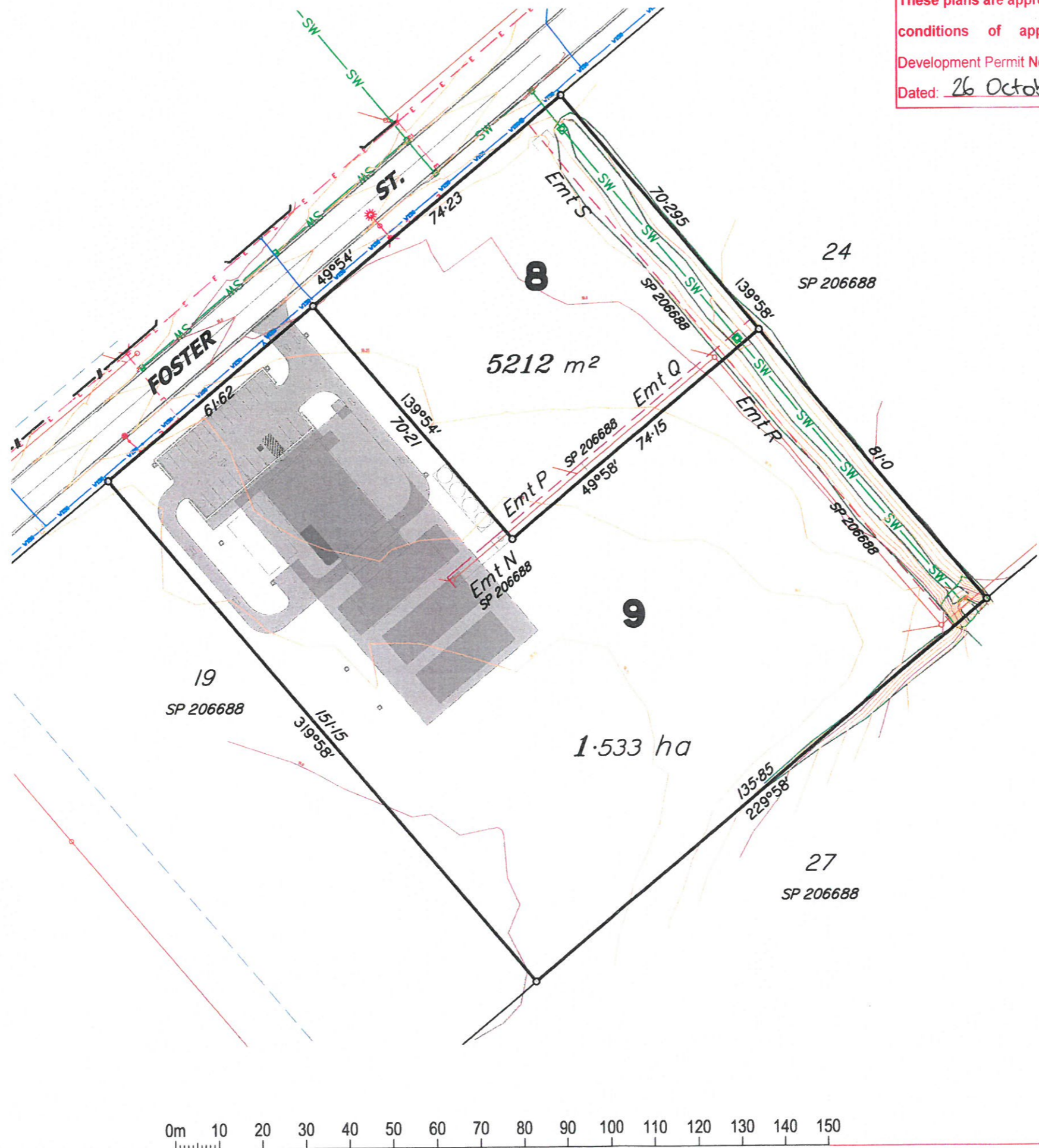

IMPORTANT NOTE

This plan was prepared to accompany an application to Rockhampton Regional Council and should not be used for any other purpose.
 The dimensions and areas shown hereon are subject to field survey and also to the requirements of council and any other authority which may have requirements under any relevant legislation.
 House plans shown are typical only.
 In particular, no reliance should be placed on the information on this plan for any financial dealings involving the land.
 This note is an integral part of this plan.

client
Rockhampton Regional Council

project
158 Foster St, GRACEMERE

plan of
Reconfiguration Plan (4 Lots into 2 Lots) (with Ortho Underlay)

rdp
Lots 20 - 23 on SP206688

lga
Rockhampton Regional Council

rev	date	details	authorised

created
 capricorn survey group (cq) Pty Ltd
 132 victoria parade, p.o. box 1301
 rockhampton qld 4700
 P 07 4927 5199
 F 07 4922 2718
 E enquiries@csq.com.au
 ABN 22 154 830 565

scale **1:1000 @ A3** datum -
 sheet no. - cad file -
 1 of 1 **6831-ROL**
 plan no. - revision -
6831-01-ROL

