

PROPERTY DETAILS

LOT 2 ON RP605021
 PARISH OF ROCKHAMPTON
 COUNTY OF LIVINGSTONE
 AREA: 653 sq.m

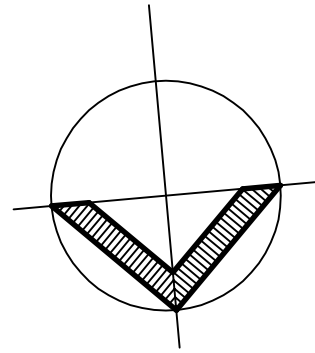

SITE PLAN NOTES:

1. Earthworks to comply with AS3798 and AS2870.1.
2. Figured dimensions shall be taken in preference to those scaled from the drawing. Builder to verify all dimensions on site prior to construction.
3. Finished surface lines shown on elevations and platform layout shall be confirmed on site prior to commencement of building work.
4. Structure designed for Wind Gust Speed : C1 (W41C)
5. All construction shall be in accordance with the requirements of the Building Code of Australia, the Building Act 1975 and the Local Authorities' requirements.
6. Timber members to be sized and fixed in accordance with C1 to A.S. 1684.
7. Builder to provide a fall around the building of :
 1 in 20 for the first 1.0m around building
 1 in 80 for the next 1.0m around building
8. Connect all new downpipes as shown and fall pipes to kerb and channel or intra allotment drainage system. Stormwater drainage design is indicative only. Plumber to verify on site the suitability of the design and adjust accordingly to suit conditions. All plumbing work to comply with relevant plumbing codes and standards.
9. Install a sleeve joint where wall downpipes meet ground stormwater lines to allow for movement.
10. Confirm location of any underground services prior to commencement of building work.
11. Check position of current mains water connection and provide connecting link to dwelling to the requirements of the Local Authority and current Water & Sewerage Supply Act. Good pressure to be achieved in supply line to building.
12. Extent of principal Builder and relevant Subcontractors to be within the confines of the property boundaries and portion of the footpath immediately adjoining front property alignment. Seek neighbours consent if access or additional construction is required outside the confines of the subject property.

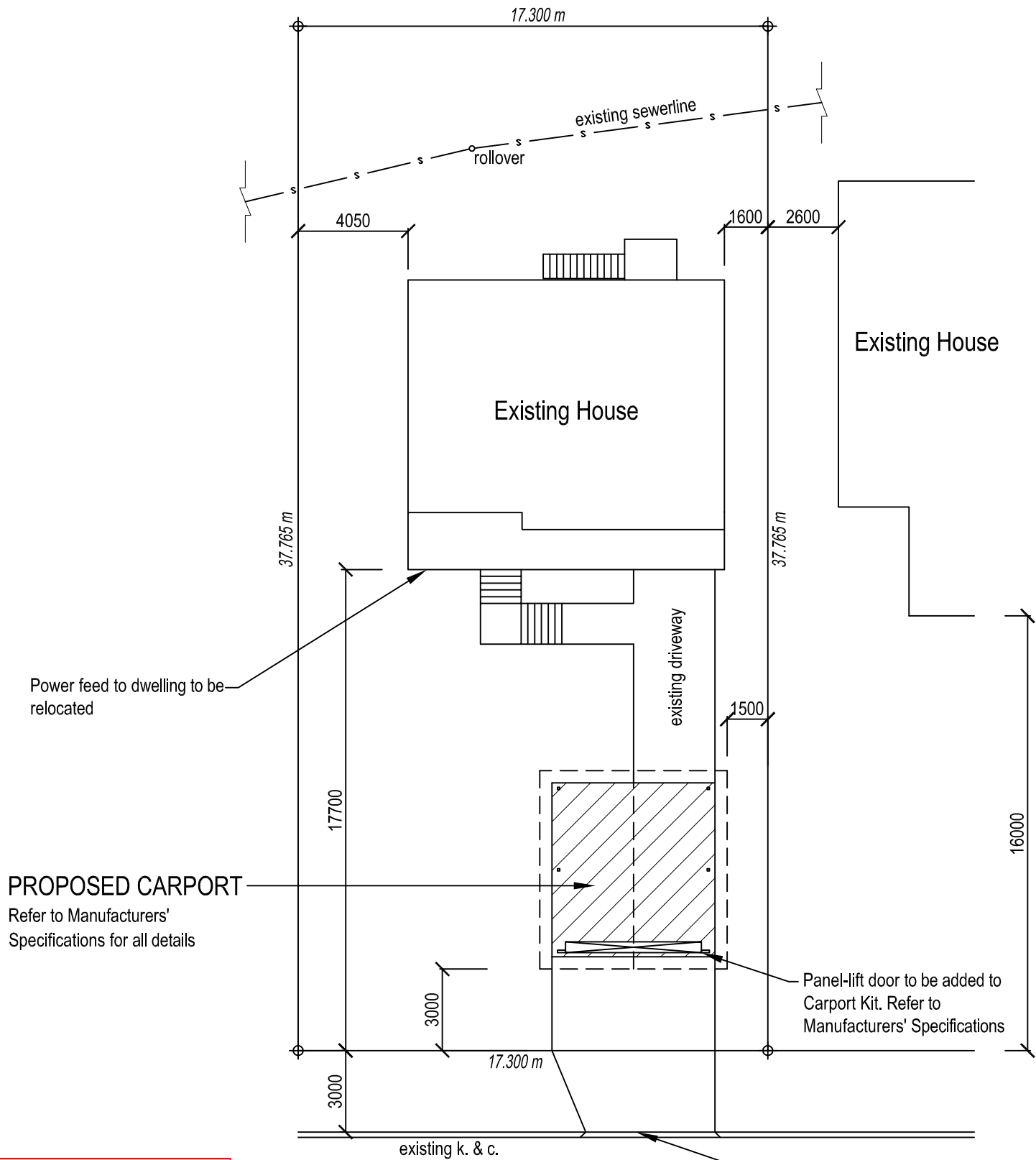

ROCKHAMPTON REGIONAL COUNCIL
APPROVED PLANS
 These plans are approved subject to the current conditions of approval associated with
Development Permit No.: D/55-2026
Dated: 12 May 2026

**CORBERY STREET
 SITE PLAN (1:200)**

No.	Date	Amendment
2	07.04.26	For Development Application
1	09.03.26	For Boundary Relaxation
P1	09.03.26	Preliminary Issue

SK Drafting
 building designs

P 07 4927 7464 M 0407 599 727
 E trent@skdrafting.com.au
 Shop 2/149 Canning Street
 Rockhampton Qld 4700
 T E Mayall Pty Ltd QBCC Lic No 15396881

skdrafting.com.au

**PROPOSED CARPORT
 AT 43 CORBERY STREET,
 THE RANGE.
 FOR A. J. & T. R. RUSSELL**

Scale as shown on A3	Date MAR '26	Issue 2
Drawn TEM	Sheet 1/1	Drawing No. 26 - 050
Checked		
Approved		

NAME
Angus Russell

SITE ADDRESS
43 CORBERRY STREET
THE RANGE QLD 4700

CONTACT
+61421638896
tragus@optusnet.com.au

Plan

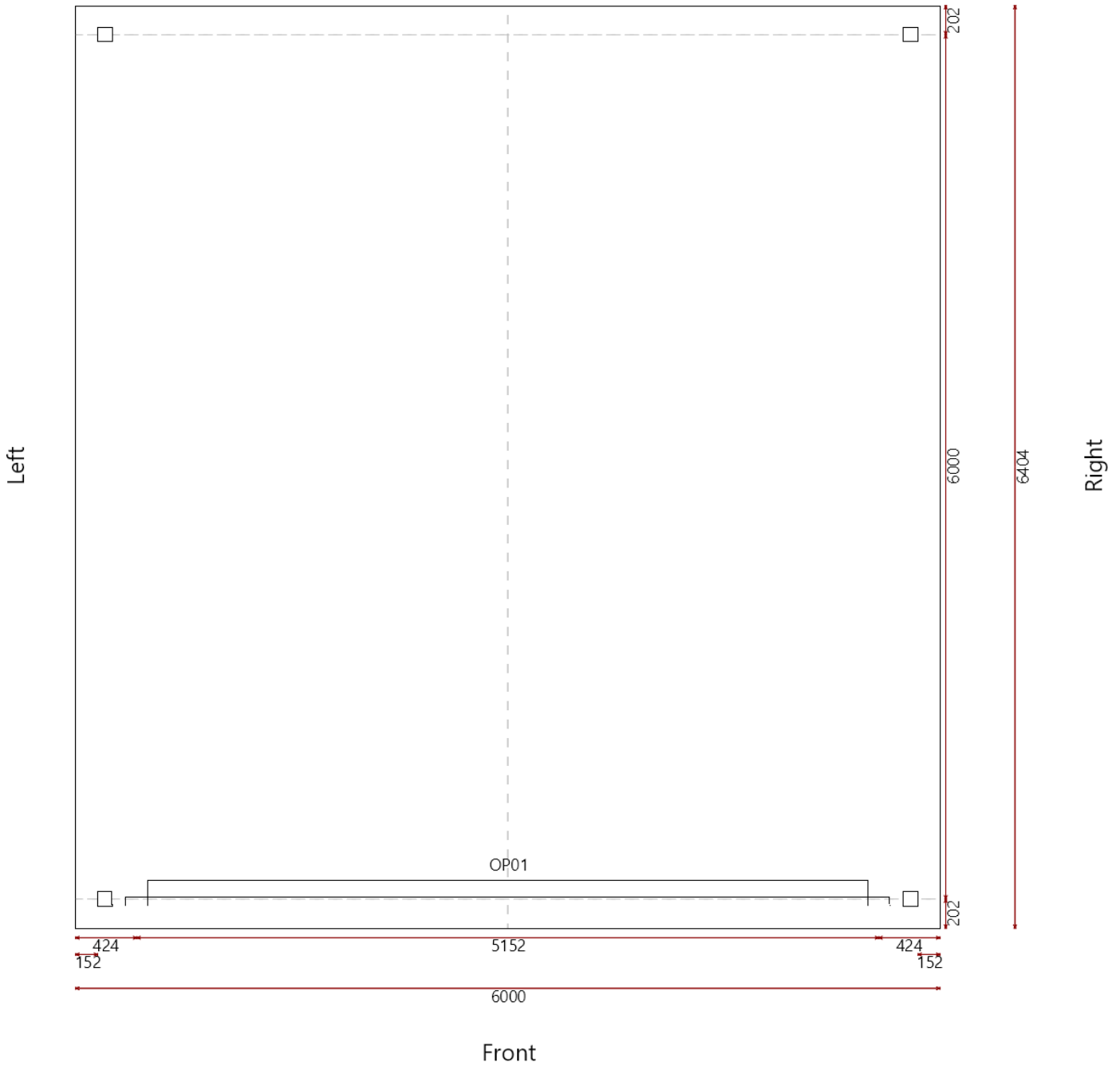

ROCKHAMPTON REGIONAL COUNCIL

APPROVED PLANS

These plans are approved subject to the current conditions of approval associated with

Development Permit No.: D/55-2026

Dated: 12 May 2026

NAME
Angus Russell

SITE ADDRESS
43 CORBERRY STREET
THE RANGE QLD 4700

CONTACT
+61421638896
tragus@optusnet.com.au

Front Elevation

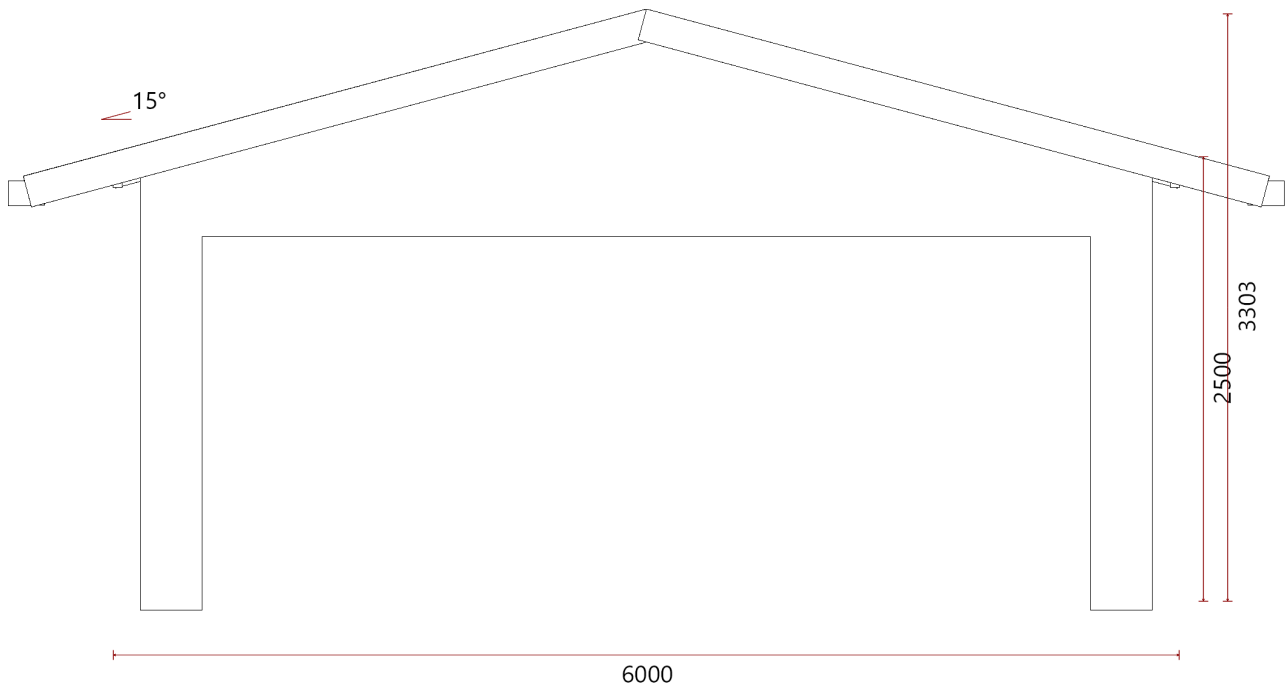

Back Elevation

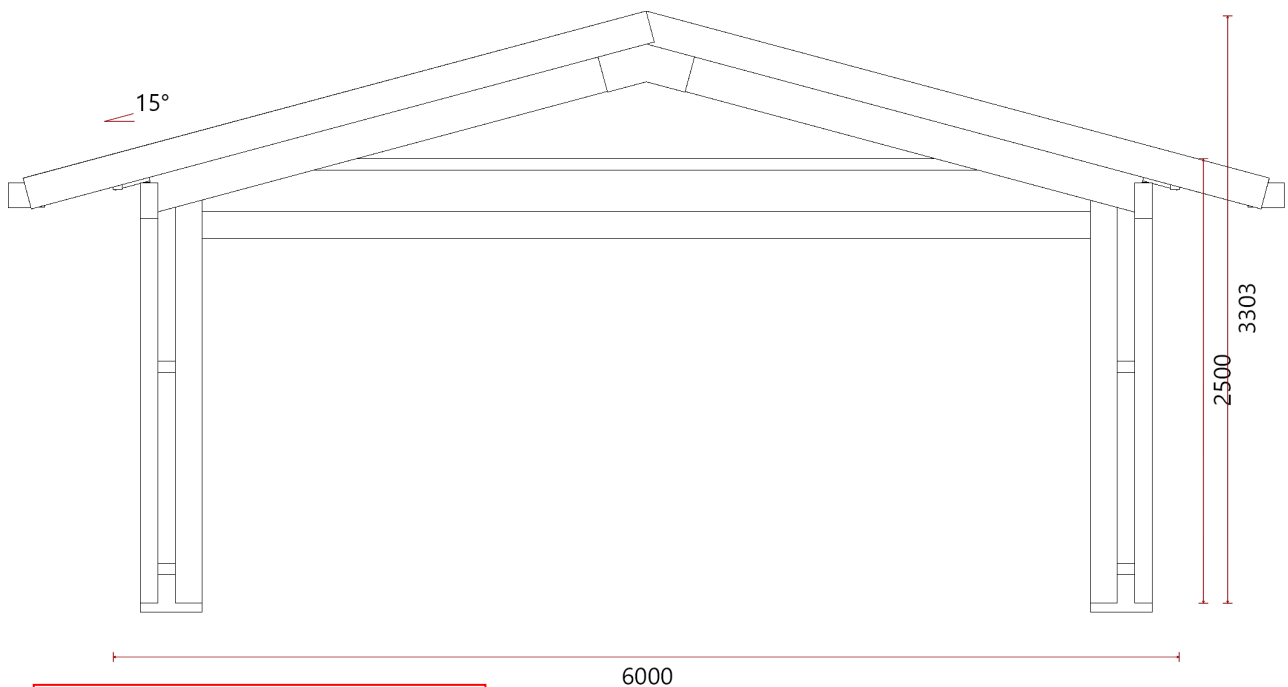

ROCKHAMPTON REGIONAL COUNCIL

APPROVED PLANS

These plans are approved subject to the current conditions of approval associated with

Development Permit No.: D/55-2026

Dated: 12 May 2026

NAME
Angus Russell

SITE ADDRESS
43 CORBERRY STREET
THE RANGE QLD 4700

CONTACT
+61421638896
tragus@optusnet.com.au

Left Elevation

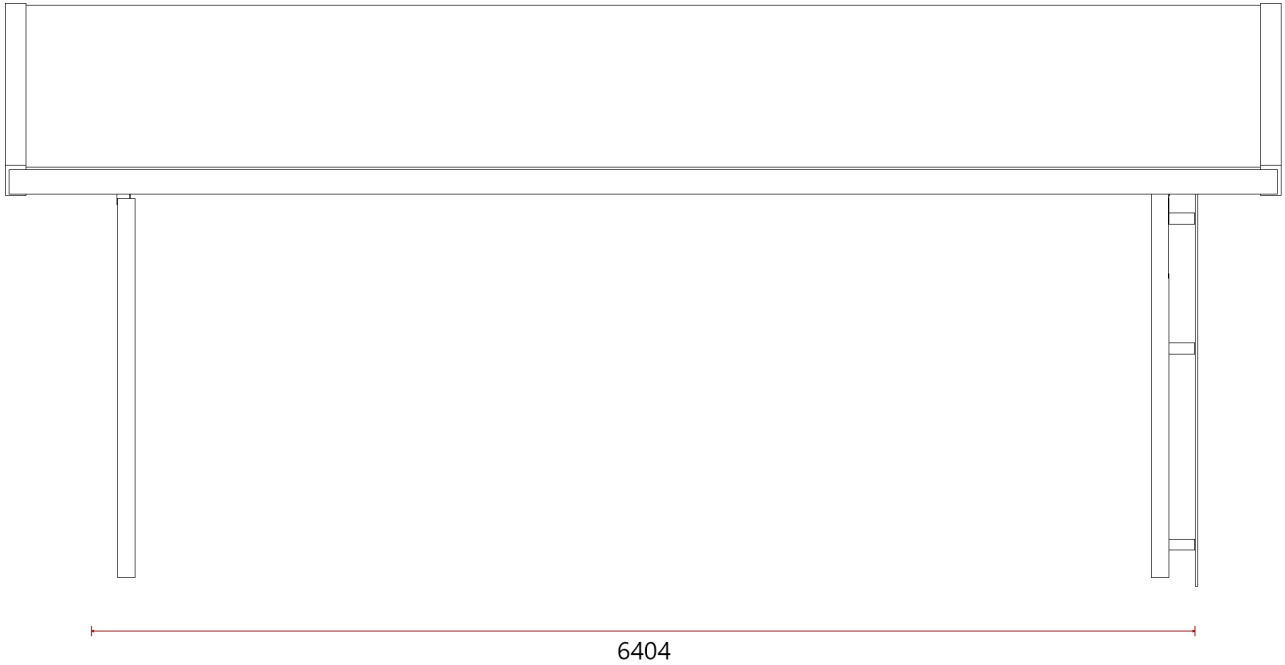

Right Elevation

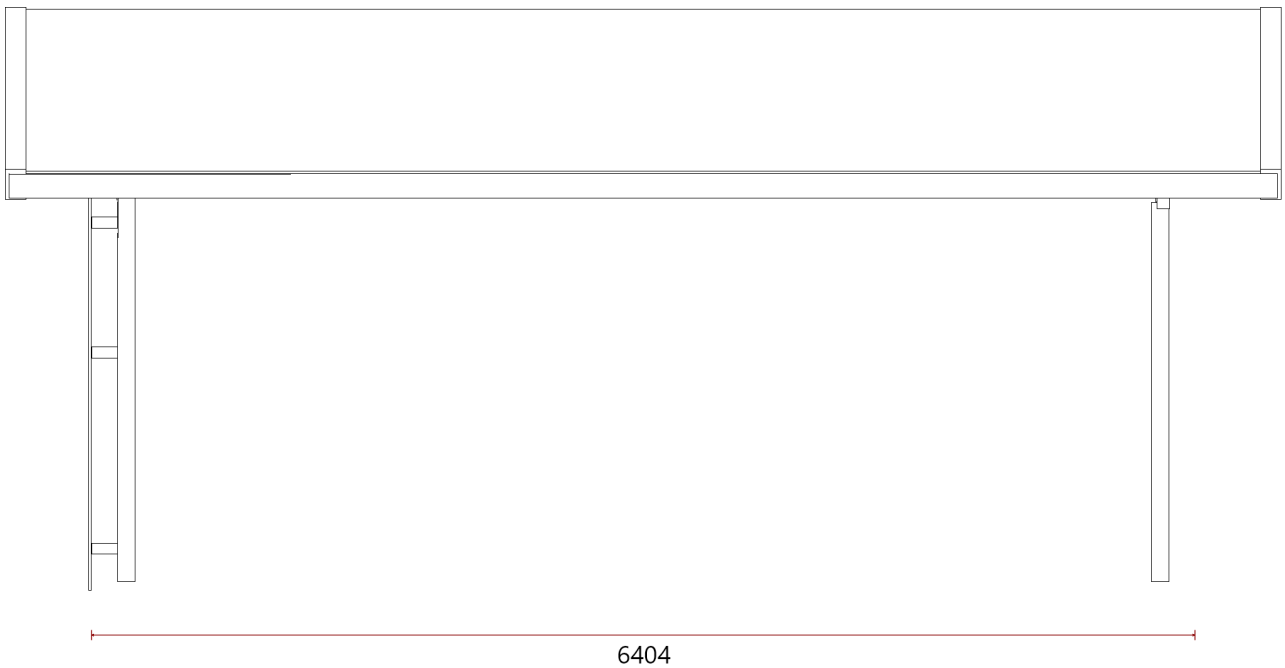

ROCKHAMPTON REGIONAL COUNCIL

APPROVED PLANS

These plans are approved subject to the current conditions of approval associated with

Development Permit No.: D/55-2026

Dated: 12 May 2026