

PERMANENT MARKS

PM	ORIGIN	BEARING	DIST	NO
10-OPM	10/IS21423	242°47'55"	29.144	90349
7-OPM	4/SP263881	168°27'40"	139.575	169206

Peg placed at all new subject corners unless
shown otherwise.

For Further Survey information see sheets 3
and 4.

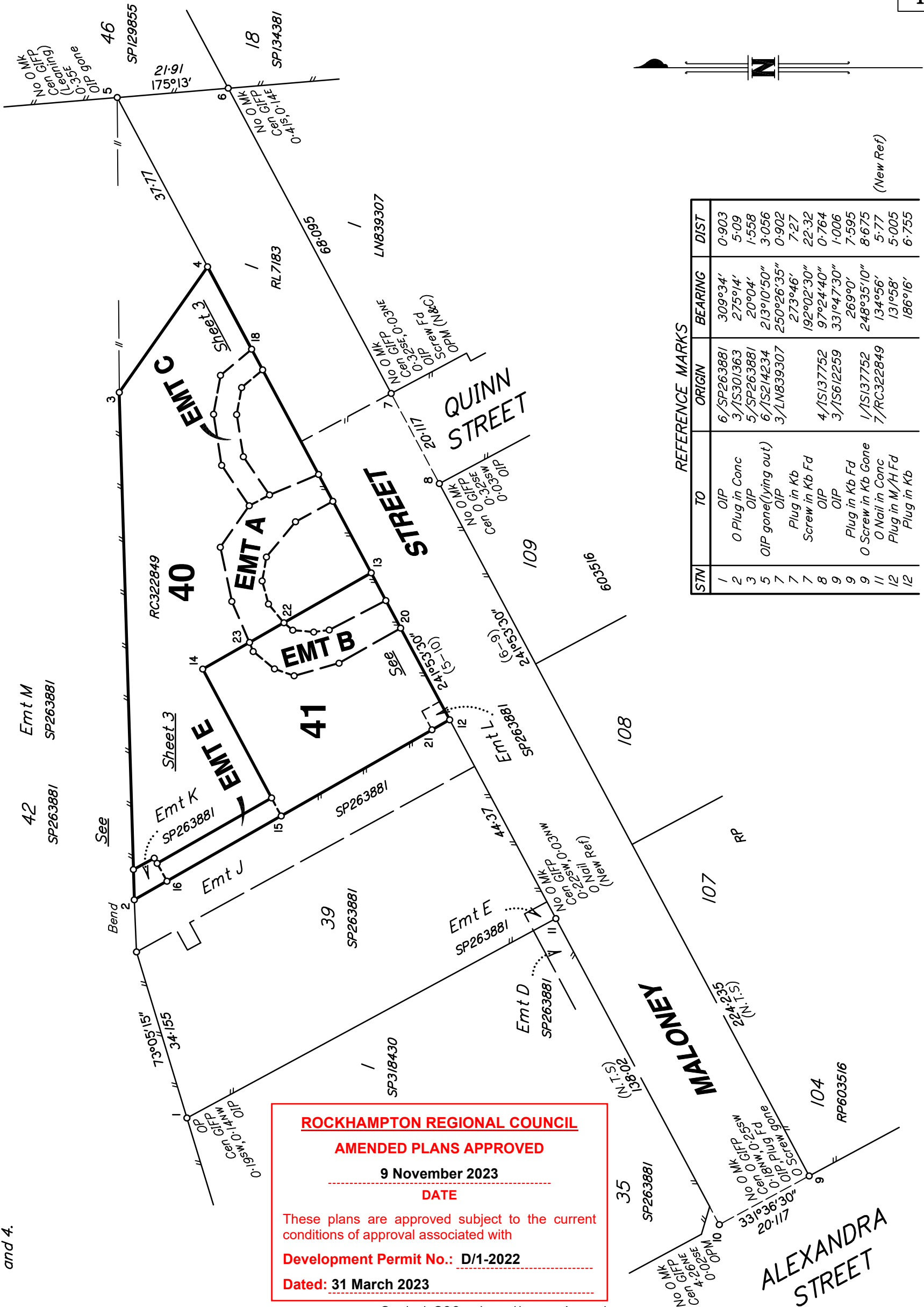

REFERENCE MARKS

STN	TO	ORIGIN	BEARING	DIST
1	OIP	6/SP263881	309°34'	0.903
2	O Plug in Conc	3/IS301363	275°14'	5.09
3	OIP	5/SP263881	20°04'	1.558
5	OIP gone(lying out)	6/IS214234	213°10'50"	3.056
7	OIP	3/LN839307	250°26'35"	0.902
7	Plug in Kb		273°46'	7.27
7	Screw in Kb Fd		192°02'30"	22.32
8	OIP	4/IS137752	97°24'40"	0.764
9	OIP	3/IS612259	33°47'30"	1.006
9	Plug in Kb Fd		269°0'	7.595
9	O Screw in Kb Fd		248°35'10"	8.675
11	O Nail in Conc	1/IS137752	134°56'	5.77
12	Plug in M/H Fd	7/RC322849	13°58'	5.005
12	Plug in Kb		186°16'	6.755

(New Ref)

Scale 1:800 – Lengths are in metres.

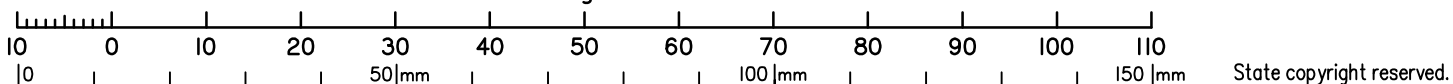

Sunrise Surveying Pty Ltd (ACN 162 352 909) hereby certify
that the land comprised in this plan was surveyed by the
corporation, by Max William KIRBY, surveying graduate, for
whose work the corporation accepts responsibility, under the
supervision of Leigh Robert James TINGLE, cadastral surveyor
and that the plan is accurate, that the said survey was
performed in accordance with the Survey and Mapping
Infrastructure Act 2003 and Surveyors Act 2003 and associated
Regulations and Standards and that the said survey was
completed on 27/07/2023.

L R Tingle
Authorised Delegate

15/09/2023

Date

**Plan of Lots 40, 41,
Easements A & C in Lot 40 and
Easements B & E in Lot 41**

Cancelling Lot 40 on SP263881

LOCAL **ROCKHAMPTON**
GOVERNMENT: **REGIONAL**

LOCALITY: **KAWANA**

Meridian: **RC322849**

Survey
Records: **No**

Scale: **1:800**

Format: **STANDARD**



SP334490

State copyright reserved.

SURVEY PLAN

ROCKHAMPTON REGIONAL COUNCIL

AMENDED PLANS APPROVED

9 November 2023

DATE

These plans are approved subject to the current conditions of approval associated with

Development Permit No.: D/1-2022

Dated: 31 March 2023

REFERENCE MARKS

STN	TO	ORIGIN	BEARING	DIST
1	O Plug in M/H	12/SP334490	131°58'	5.005
1	O Plug in Kb	12/SP334490	186°16'	6.755
4	OIP	3/LN839307	250°26'35"	0.902
4	O Plug in Kb	7/SP334490	273°46'	7.27
4	O Screw in Kb	7/SP334490	192°02'30"	22.32
7	O Screw in Kb	2/SP203592	252°53'55"	6.202
8	OIP	29/LN2218	34°12'20"	1.0
8	O Screw in Kb	1/SP203592	237°39'25"	6.662
9	OIP	4/IS137752	97°24'40"	0.764

For clarity purposes 'x'
denotes Deck Spk Pld flush at Stn.

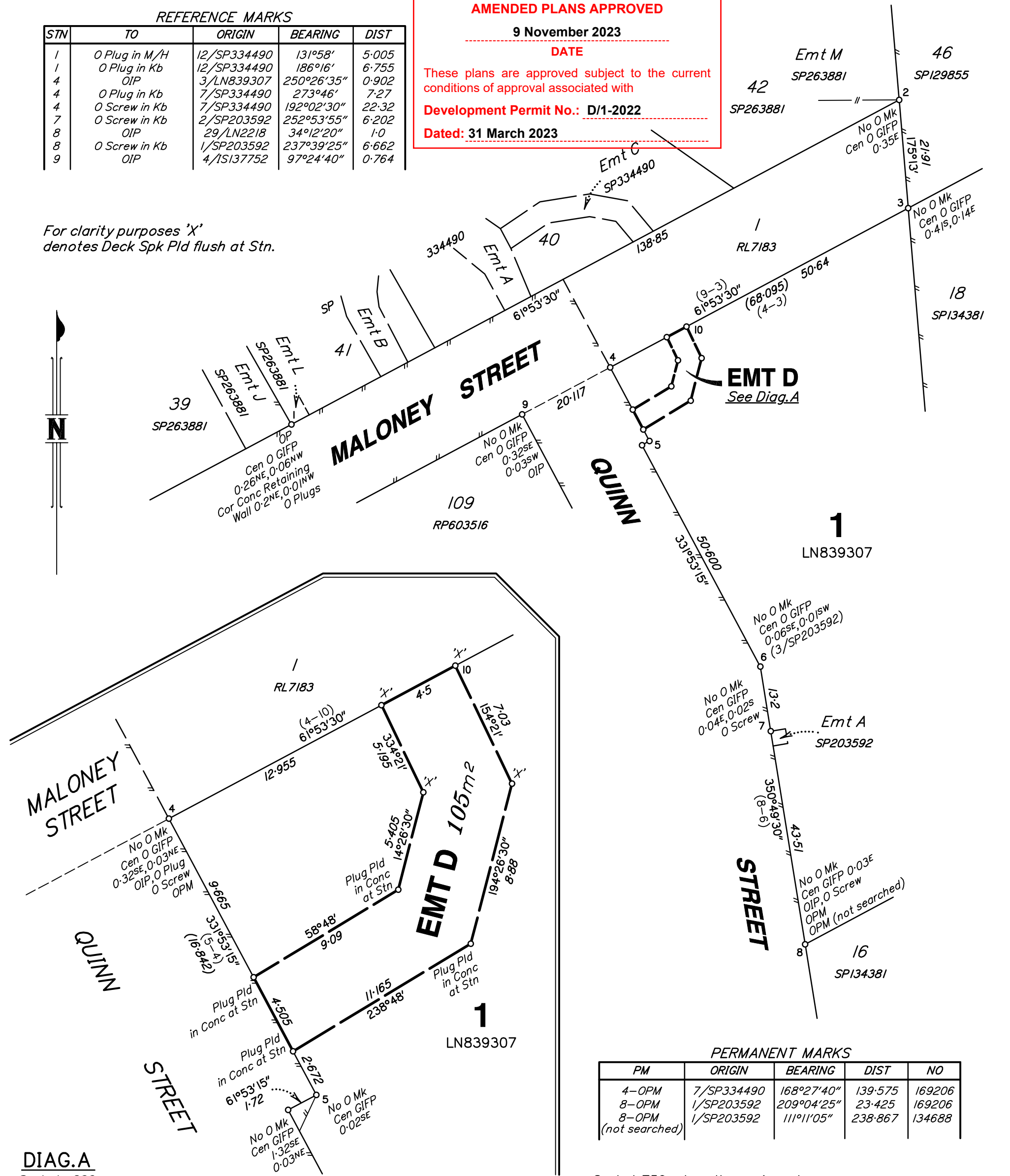

DIAG.A

Scale 1: 200

Scale 1: 750 – Lengths are in metres.

Sunrise Surveying Pty Ltd (ACN 162 352 909) hereby certify that the land comprised in this plan was surveyed by the corporation, by Max William KIRBY, surveying graduate, for whose work the corporation accepts responsibility, under the supervision of Leigh Robert James TINGLE, cadastral surveyor and that the plan is accurate, that the said survey was performed in accordance with the Survey and Mapping Infrastructure Act 2003 and Surveyors Act 2003 and associated Regulations and Standards and that the said survey was completed on 28/07/2023.

L R Tingle
Authorised Delegate

15/09/2023

Date

LOCAL ROCKHAMPTON
GOVERNMENT: REGIONAL

LOCALITY: KAWANA

Meridian: SP334490

Survey Records: No

Plan of Easement D

in Lot 1 on LN839307

Scale: 1:750

Format: STANDARD

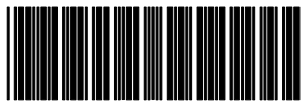

SP334491