

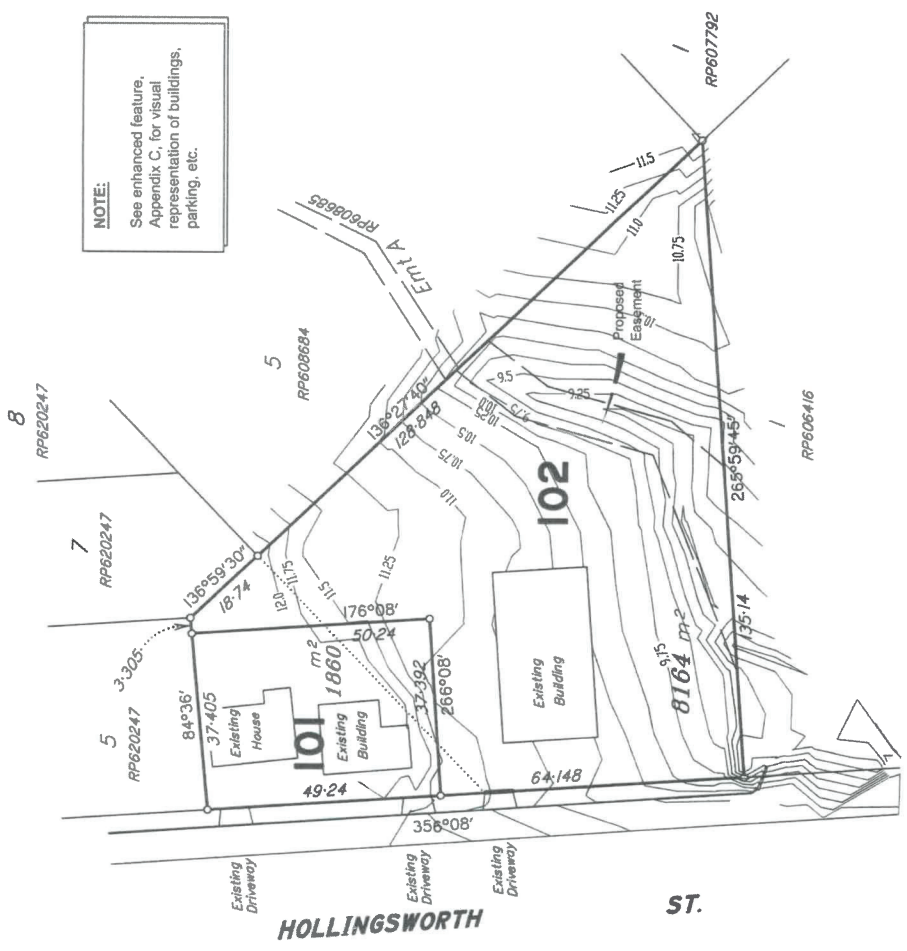

**NOTE:**  
See enhanced feature, Appendix C, for visual representation of buildings, parking, etc.



**ROCKHAMPTON REGIONAL COUNCIL**  
**APPROVED PLANS**  
These plans are approved subject to the current conditions of approval associated with **Development Permit No.: D/42-2018**  
**Dated: 06 June 2018**

Rev No	Revision note	Date	Signature	Checked

<p><b>Notes:</b> This plan was prepared to accompany a subdivision application to the Rockhampton Regional Council and should not be used for any other purpose. The dimensions and areas shown hereon are subject to field survey and shall be subject to the requirements of any relevant legislation. In particular, no reliance should be placed on the information on this plan for any financial dealings involving the land. Scan Contours on KRP derived from PSM 104339. This note is an integral part of the plan.</p>	<p>Horizontal Datum: <b>C.A.M.</b></p> <p>Meridian: <b>RP 608491</b></p> <p>Vertical Datum: <b>A.H.D.</b></p> <p>Derived from: <b>PSM 104339</b></p>	<p>Scale: <b>1:1000</b></p> <p>AutoCAD Scale: <b>1:1000</b></p> <p>Keypoints Run: -</p> <p>Backup Ref: -</p> <p>Date: -</p>	<p>Drawn: <b>DCE</b></p> <p>Date: <b>10-8-2011</b></p> <p>Checked: -</p> <p>Date: -</p>	<p>Scale: <b>1:1000</b></p> <p>Parish: <b>MURCHISON</b></p> <p>County: <b>Livingstone</b></p> <p>Ref: <b>5000-10</b></p> <p>Rev: <b>A</b></p>
	<p><b>Proposed Survey of</b> <b>Lots 102 &amp; 102</b> <b>Cancelling Lot 1 on RP 608491</b> <b>and Lot 1 on RP 603785</b></p>	<p><b>SCHLENCKER SURVEYING</b> A.B.N. 54 516 250 722 SURVEYING, MAPPING &amp; DEVELOPMENT CONSULTANTS 181 East St., ROCKHAMPTON Ph. (07) 4822 1744 Fax. (07) 4822 3164 Also at BRISBANE &amp; GOLD COAST</p>	<p>© 2011 Schlencker Surveying</p>	

