

**IMPORTANT NOTE**

- This plan was prepared for the sole use of the client for the specific purpose of producing a plan. This plan is strictly limited to that purpose and does not apply directly or indirectly and will not be used for any other application, use or matter. The plan is presented without the assumption of a duty of care to any other person (other than the Client) ("Third Party") and may not be relied on by Third Party.
- MPA Surveying will not be liable (in negligence or otherwise) for any direct or indirect loss, damage, liability or claim arising out of or incidental to:
  - Third Party publishing, using or relying on the plan;
  - MPA Surveying relying on information provided to it by the Client or a Third Party where the information is incorrect, incomplete, inaccurate, out-of-date or unreasonable;
  - any inaccuracies or other faults with information or data sourced from a Third Party;
  - MPA Surveying relying on surface indications that are incorrect or inaccurate;
  - the Client or any Third Party not verifying information in this plan where recommended by MPA Surveying;
  - judgment of this plan with any local authority, against the recommendation of MPA Surveying;
  - the accuracy, reliability, suitability or completeness of any approximations or estimates made or referred to by MPA Surveying.
- Without limiting paragraph 1 or 2 above, this plan may not be copied, distributed, or reproduced by any process unless this note is clearly displayed on the plan.
- Dimensions and Areas are approximate only and are subject to a final survey

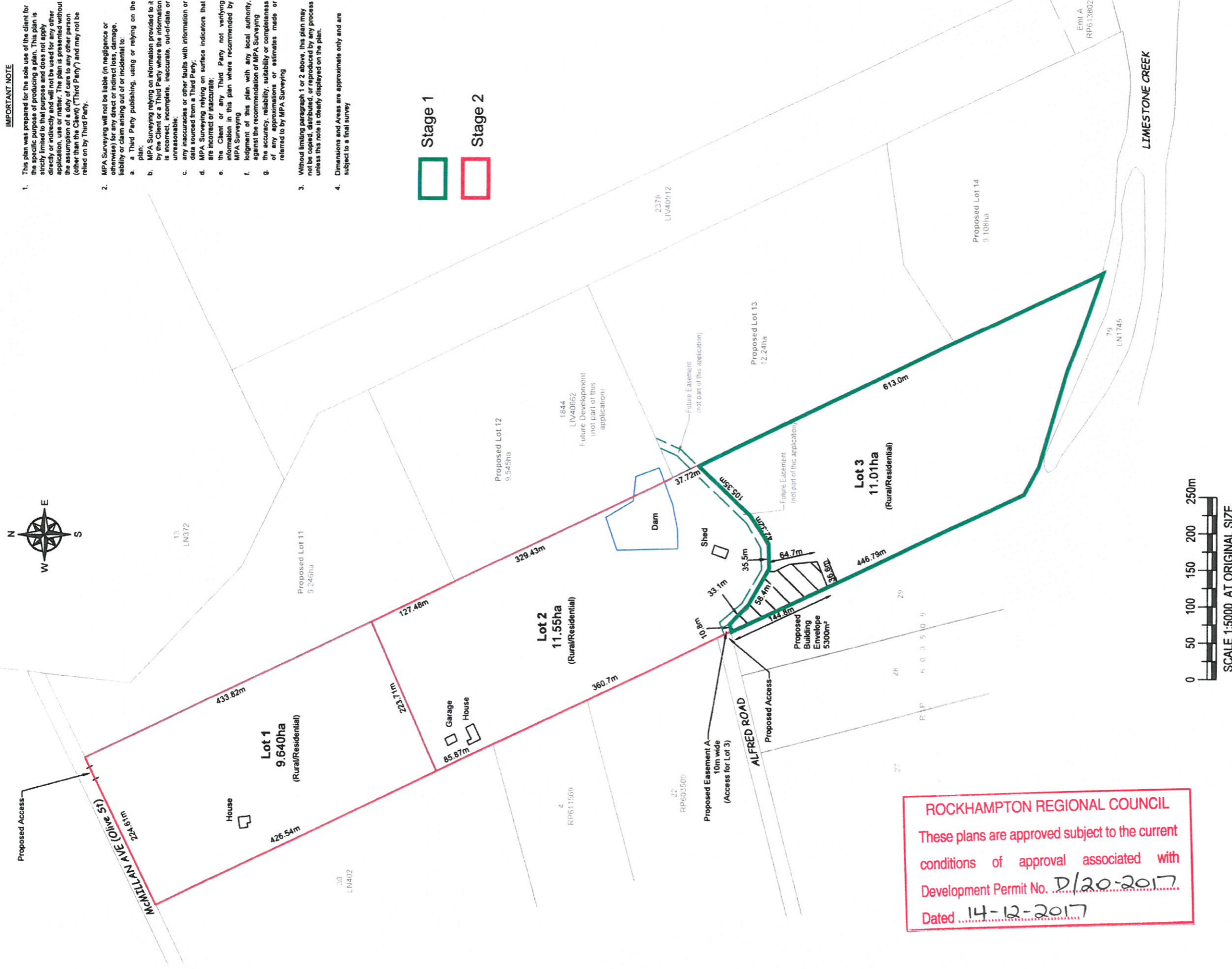

**ROCKHAMPTON REGIONAL COUNCIL**  
 These plans are approved subject to the current conditions of approval associated with Development Permit No. D/20-2017  
 Dated 14-12-2017

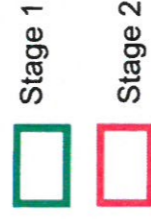

Project: Lot 485 LIV40112 Subdivision		MPA Job No: R17003	Scale: 1:5000 at A3
Title: Proposed Subdivision Layout		Level Datum:	Co-ord System:
Client: Reel Planning		MPA Drawing No: R17003-001	Sheet: 1 of 1
C	Amend Easement & Lot Boundary	18/10/2017	SP
B	Layout Amendments	29/3/17	KN
A	Original Issue	13/2/17	KN
Rev.	Reason for Issue or Amendment	Date	Drawn
			Checked
			Surveyed

**HOFFMANN SURVEYORS**

Head Office 37 Withers St. Rockhampton, QLD 4701 P 07 4922 3854 hoffmannsurveyors.com.au  
 Rockhampton Longreach Blackall Charleville CADASTRAL ENGINEERING MAPPING TOWN PLANNING

