

REFERENCE MARKS

STM	TO	ORIGIN	BEARING	DIST
1	O.Nail in Kerb	1/SP293757	143°51'30"	7.782
4	O.Nail in Conc Median	6/SP285395	199°39'45"	5.717
15	O.Nail in Kerb	9/SP285395	293°40'	16.667

New Ref

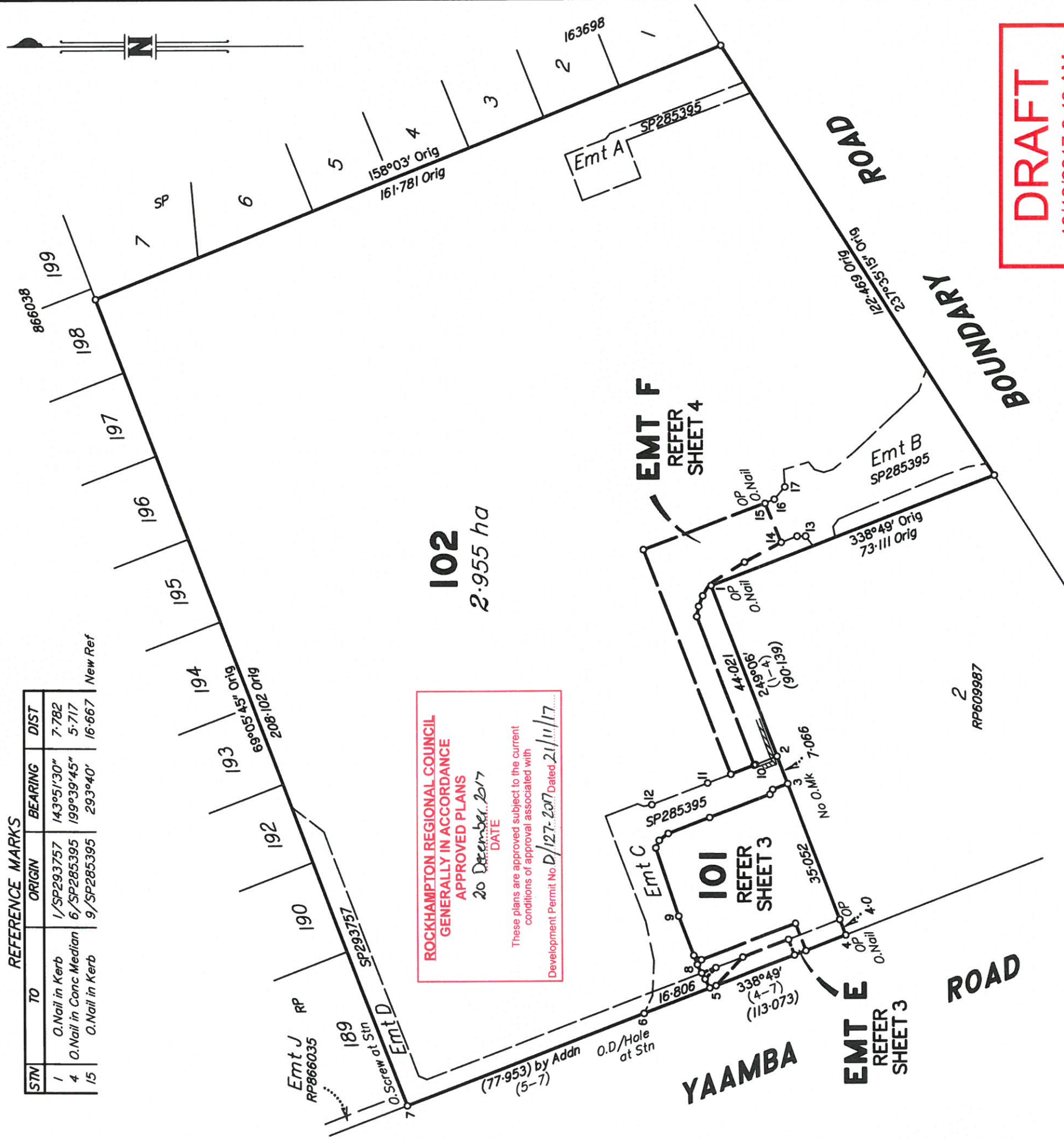

ROCKHAMPTON REGIONAL COUNCIL
GENERALLY IN ACCORDANCE
APPROVED PLANS
 20 December 2017
 DATE

These plans are approved subject to the current conditions of approval associated with Development Permit No. D/127-2017 Dated 21/11/17

DRAFT
 19/12/2017 9:49 AM

Reinstatement Report:

Plans Searched: SP293757, SP285395 and SP224442

All original stations fixed by original monuments and/or recovery marks, and dimensions agree with the previous surveys, with the exception of station 15, where the corner was fixed by O.Drill hole in back of kerb. An excess of 0.090m was measured and shown between stations 14 and 15, and an excess of 0.006 measured and shown between stations 15 and 16, when compared with the previous survey SP285395.

Drill Hole in Kerb placed at all new Stations unless noted otherwise.

Original information compiled from SP224442 & SP285395 in the Department of Natural Resources & Mines

Scale 1:1000 - Lengths are in Metres.



Plan of Lots 101 & 102 and
Easements E & F in Lots 101
& 102 Respectively

Scale: 1:1000

Format: STANDARD

Cancelling Lot 15 on SP224442

LOCAL GOVERNMENT: ROCKHAMPTON REGIONAL
 LOCALITY: PARKHURST
 Survey Records: No

SP296885

VISION SURVEYS (QLD) PTY LTD (ABN 84 128 752 947) hereby certify that the land comprised in this plan was surveyed by the corporation, by Christian Michael DAVIES, Surveying Graduate, and Wade Lawrence ELLIOTT, Surveying Associate, for whose work the corporation accepts responsibility, under the supervision of Brian James FORRESTER, Cadastral Surveyor, and that the plan is accurate, that the said survey was performed in accordance with the Survey and Mapping Infrastructure Act 2003 and Surveyors Act 2003 and associated Regulations and Standards and that the said survey was completed on 18/12/2017.

..... Date

Authorised Delegate