



SARA reference: 2208-30246 SRA
 Council reference: D/98-2022

29 September 2022

Chief Executive Officer
 Rockhampton Regional Council
 PO Box 1860
 Rockhampton Qld 4700
 enquiries@rrc.qld.gov.au

Attention: Sophie Muggeridge

Dear Sir/Madam

SARA response—540 Weir Park Road, Gogango

(Referral agency response given under section 56 of the *Planning Act 2016*)

The development application described below was confirmed as properly referred by the State Assessment and Referral Agency (SARA) on 25 August 2022.

Response

Outcome:	Referral agency response – with conditions.
Date of response:	29 September 2022
Conditions:	The conditions in Attachment 1 must be attached to any development approval.
Advice:	Advice to the applicant is in Attachment 2 .
Reasons:	The reasons for the referral agency response are in Attachment 3 .

Development details

Description:	Development permit Reconfiguring a lot - Boundary realignment
SARA role:	Referral Agency.
SARA trigger:	Schedule 10, part 3, division 4, table 2, item 1 (Planning Regulation 2017) Development application for a reconfiguring a lot involves native vegetation clearing
SARA reference:	2208-30246 SRA

Assessment Manager: Rockhampton Regional Council
Street address: 540 Weir Park Road, Gogango; , Gogango
Real property description: 3SP318753; 4SP318753
Applicant name: the State of Queensland
Applicant contact details: PO Box 450
Rockhampton QLD 4700
gg@gideontownplanning.com.au

Representations

An applicant may make representations to a concurrence agency, at any time before the application is decided, about changing a matter in the referral agency response (s.30 Development Assessment Rules) Copies of the relevant provisions are in **Attachment 4**.

A copy of this response has been sent to the applicant for their information.

For further information please contact Carl Porter, Principal Planning Officer, on 07 3243 1666 or via email RockhamptonSARA@dspdilgp.qld.gov.au who will be pleased to assist.

Yours sincerely



Graeme Kenna
Manager (Planning)

cc the State of Queensland, gg@gideontownplanning.com.au

enc Attachment 1 - Referral agency conditions
Attachment 2 - Advice to the applicant
Attachment 3 - Reasons for referral agency response
Attachment 4 - Representations provisions
Attachment 5 - Approved plans and specifications

Attachment 1—Referral agency conditions

(Under section 56(1)(b)(i) of the *Planning Act 2016* the following conditions must be attached to any development approval relating to this application) (Copies of the plans and specifications referenced below are found at Attachment 5)

No.	Conditions	Condition timing
Reconfiguring a lot		
Schedule 10, part 3, division 4, table 2, item 1 (Planning Regulation 2017)— The chief executive administering the <i>Planning Act 2016</i> nominates the Director-General of Department of Resources to be the enforcement authority for the development to which this development approval relates for the administration and enforcement of any matter relating to the following condition(s):		
1.	Clearing of vegetation must: <ul style="list-style-type: none"> (a) only occur within Area A(A1) as shown on the attached: <ul style="list-style-type: none"> (i) Vegetation Management Plan, prepared by Queensland Government, reference VMP 2208-30246 SRA, Sheet 1 of 1, version 1; and (ii) Attachment to Vegetation Management Plan VMP 2208-30426 SRA Derived Reference Points for GPS; (a) Not exceed 0.17 hectares. 	At all times
2.	Any person(s) engaged or employed to carry out the clearing of vegetation under this development approval must be provided with a full copy of this development approval and must be made aware of the full extent of clearing authorised by this development approval.	Prior to clearing

Attachment 2—Advice to the applicant

General advice	
1.	Terms and phrases used in this document are defined in the <i>Planning Act 2016</i> its regulation or the State Development Assessment Provisions (SDAP) 3.0. If a word remains undefined it has its ordinary meaning.

Attachment 3—Reasons for referral agency response

(Given under section 56(7) of the *Planning Act 2016*)

The reasons for SARA's decision are:

- The proposed development is for a boundary realignment to facilitate the construction of Rookwood Weir
- The proposed boundary realignment will have minimal impact on regulated vegetation.
- The proposed development complies with the relevant parts of State Code 8 with the application of conditions.

Material used in the assessment of the application:

- The development application material and submitted plans
- *Planning Act 2016*
- Planning Regulation 2017
- The *State Development Assessment Provisions* (version 3.0), as published by the department
- The Development Assessment Rules
- SARA DA Mapping system

Attachment 4—Change representation provisions

(page left intentionally blank)

Attachment 5—Approved plans and specifications

(page left intentionally blank)

LOCALITY

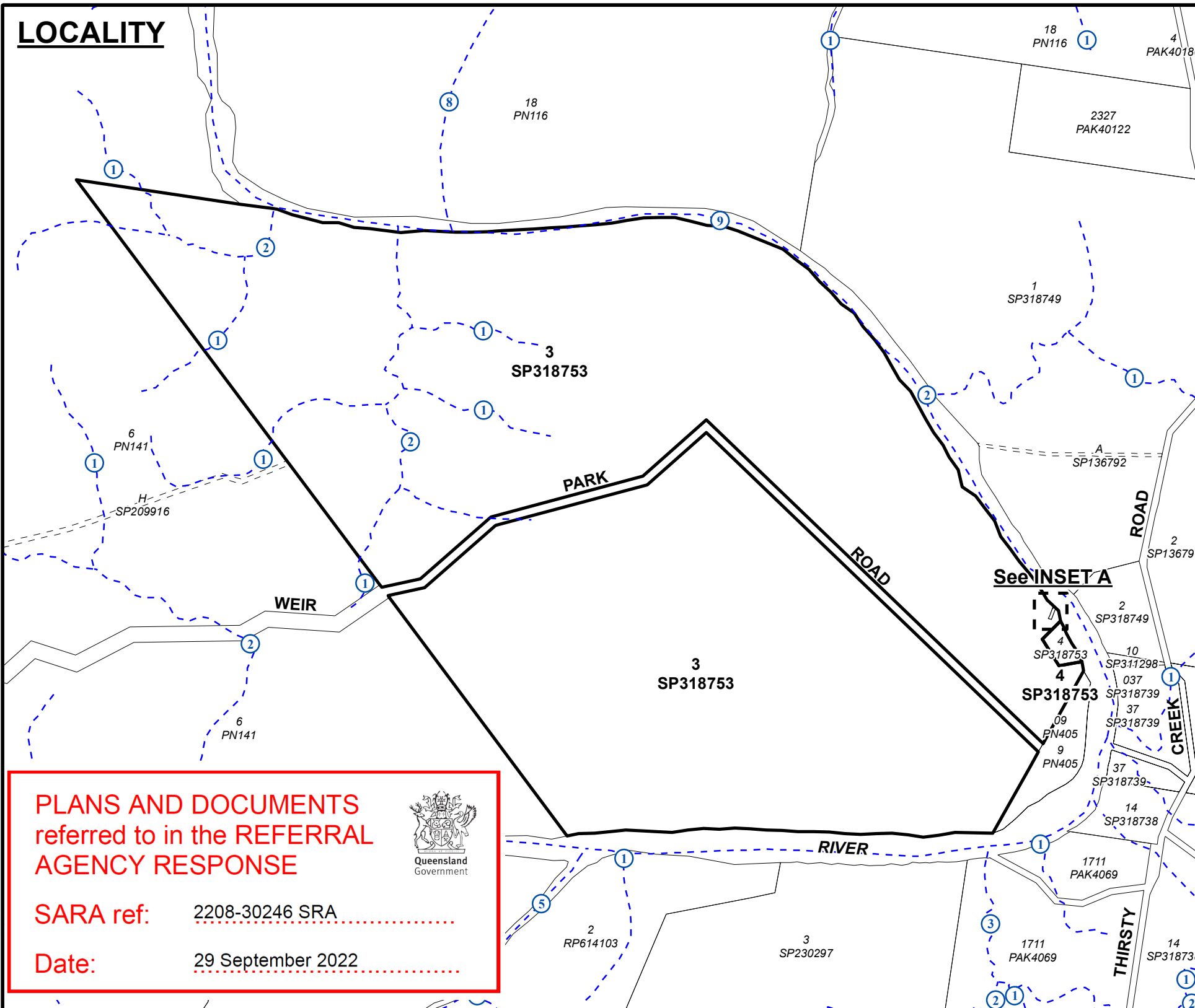

INSET A

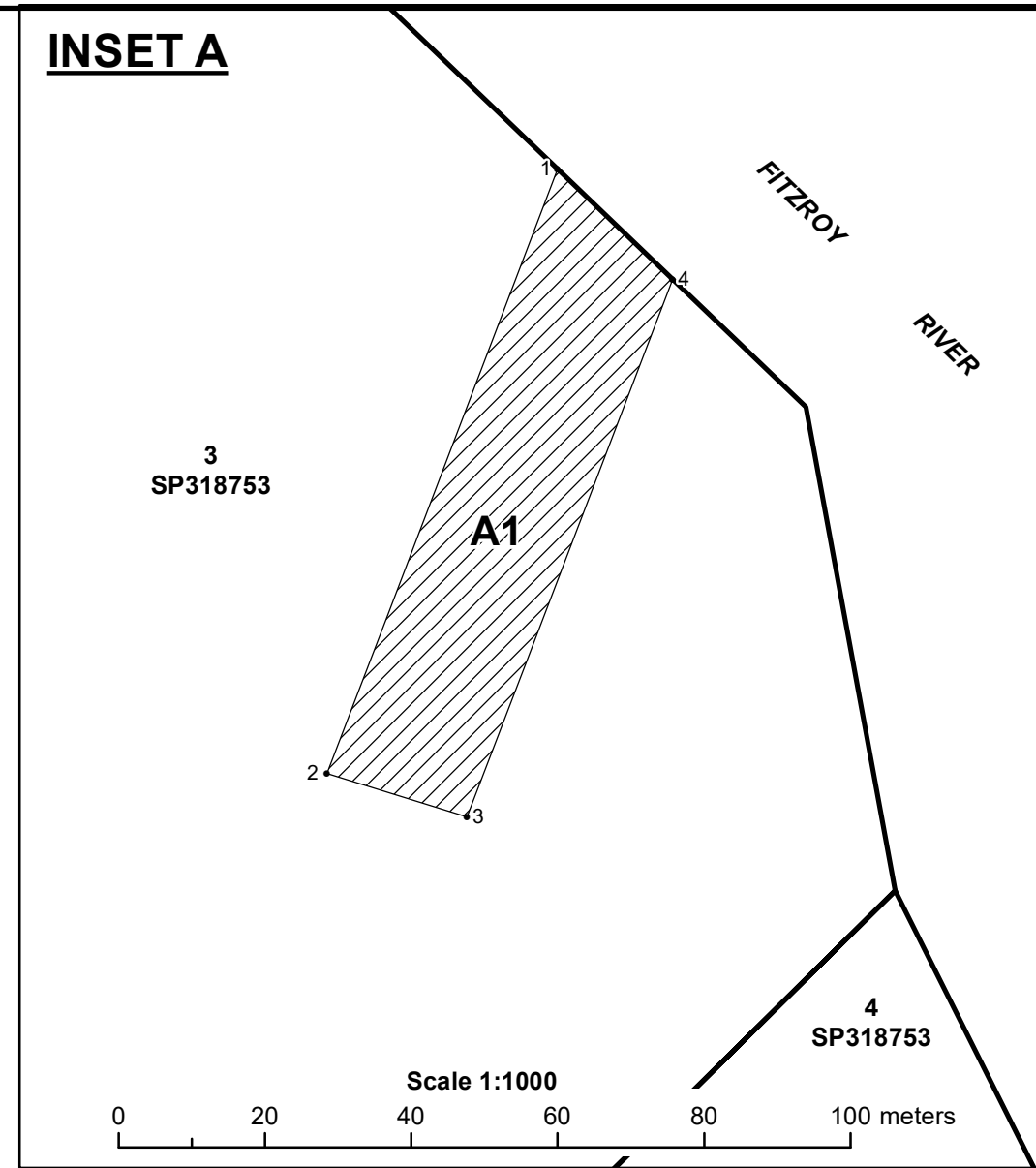

PLANS AND DOCUMENTS referred to in the REFERRAL AGENCY RESPONSE

SARA ref: 2208-30246 SRA





Date: 29 September 2022



Derived Reference Points
 Projection: GDA2020 MGA Zone 55
 Datum: GDA 2020

Area	Point	Easting	Northing
A1	1	807661	7393510
A1	2	807629	7393427
A1	3	807648	7393422
A1	4	807676	7393495

LEGEND

- 2 Derived Reference Points
-  Subject Lots
-  Area A - Clearing permitted
-  Land Parcels
-  Easements
-  Watercourse and/or drainage feature (Stream order label)

Note: This is a colour plan and must be reproduced in colour.

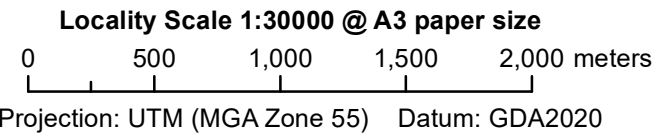
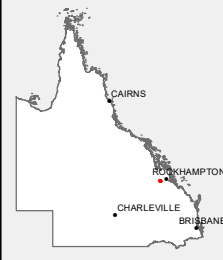

This plan must be read in conjunction with conditions attached to 2208-30246 SRA

Note: Derived Reference Points are provided to assist in the location of area boundaries. Responsibility for locating these boundaries lies solely with the landholder.

Watercourse and drainage feature locations shown on the Vegetation Management Plan are derived from the certified Vegetation Management Watercourse and Drainage Feature Map. These alignments are approximate only and require ground truthing to identify the exact location of the watercourse or drainage feature. The property boundaries shown on this plan are APPROXIMATE ONLY. They are NOT an accurate representation of the legal boundaries.

Vegetation Management Plan

Plan of Area A (Part A1) in Lots 3 and 4 on SP318753

Version: 1

eLVAS Case ID: 2022/002471



© The State of Queensland 2022

VMP
2208-30246 SRA
 Sheet 1 of 1

Development Assessment Rules—Representations about a referral agency response

The following provisions are those set out in sections 28 and 30 of the Development Assessment Rules¹ regarding **representations about a referral agency response**

Part 6: Changes to the application and referral agency responses

28 Concurrence agency changes its response or gives a late response

- 28.1. Despite part 2, a concurrence agency may, after its referral agency assessment period and any further period agreed ends, change its referral agency response or give a late referral agency response before the application is decided, subject to section 28.2 and 28.3.
- 28.2. A concurrence agency may change its referral agency response at any time before the application is decided if—
- (a) the change is in response to a change which the assessment manager is satisfied is a change under section 26.1; or
 - (b) the Minister has given the concurrence agency a direction under section 99 of the Act; or
 - (c) the applicant has given written agreement to the change to the referral agency response.²
- 28.3. A concurrence agency may give a late referral agency response before the application is decided, if the applicant has given written agreement to the late referral agency response.
- 28.4. If a concurrence agency proposes to change its referral agency response under section 28.2(a), the concurrence agency must—
- (a) give notice of its intention to change its referral agency response to the assessment manager and a copy to the applicant within 5 days of receiving notice of the change under section 25.1; and
 - (b) the concurrence agency has 10 days from the day of giving notice under paragraph (a), or a further period agreed between the applicant and the concurrence agency, to give an amended referral agency response to the assessment manager and a copy to the applicant.

¹ Pursuant to Section 68 of the *Planning Act 2016*

² In the instance an applicant has made representations to the concurrence agency under section 30, and the concurrence agency agrees to make the change included in the representations, section 28.2(c) is taken to have been satisfied.

Part 7: Miscellaneous

30 Representations about a referral agency response

- 30.1. An applicant may make representations to a concurrence agency at any time before the application is decided, about changing a matter in the referral agency response.³

³ An applicant may elect, under section 32, to stop the assessment manager's decision period in which to take this action. If a concurrence agency wishes to amend their response in relation to representations made under this section, they must do so in accordance with section 28.