



K E R S H A W  
G A R D E N S

---

L A N D S C A P E  
R E V I T A L I S A T I O N  
C O N C E P T



ARTIST IMPRESSION - NATURE PLAY

When devastation takes away a part of the city, a part of our everyday life that we have come to love and frequent, it brings with it an opportunity to **rebuild, reinvigorate and redefine** its role through positive change for future generations. The revitalisation of Kershaw Gardens will celebrate our tightly bound community and our unique climate and environment to become **a space for all people.**

## CONTENTS

- 01 *A Unique Opportunity*
- 02 *Design Drivers and Benchmarks*
- 03 *A Placemaking Strategy*
- 04 *A Vision for the Future*
- 05 *Design Concept*
- 06 *Landscape Masterplan*
- 07 *Strategies for Character and Details*

## 01 A UNIQUE OPPORTUNITY

---

All great cities are made up of a network of open spaces that together form a successful and complementary system. For greater public value and community uplift, it is important to ensure all future works create a unique setting that are site based and do not compete with other open spaces within the urban grain. Over the past few decades, Kershaw Gardens has undergone a series of minor upgrade projects which from a strategic sense have continued to further develop its role within the city. As part of the future transformation, the revitalised Kershaw Gardens will build on success factors of prior works to cement its strategic position within its city context.



EXISTING ELEMENTS TO BE  
RETAINED AND IMPROVED

Currently Kershaw Gardens provides an array of landscape environments and elements that drive usage and utilisation of the open space. Through investigation and conversation the following images represent existing environs and elements to be retained and enhanced in the revitalisation concept.



## 02 DESIGN DRIVERS AND BENCHMARKS

---

The following section summarises the key design drivers that will determine how Kershaw Gardens will evolve in the future. The revitalisation will build on the existing elements and inject these new components to meet community needs and desires. These key drivers have been benchmarked against exemplar parks to deliver desired outcomes and key learnings for Kershaw Gardens. The following design drivers ensure a diverse range of activity is available for the people as part of their daily life.

# A DIVERSE DISPLAY OF OUR FLORA

1

## BENCHMARK PROJECT

- Australian Garden (Melbourne)



RECREATION IN A SHADED NATURAL ENVIRONMENT

2

BENCHMARK PROJECT

- Robelle Domain (Ipswich)

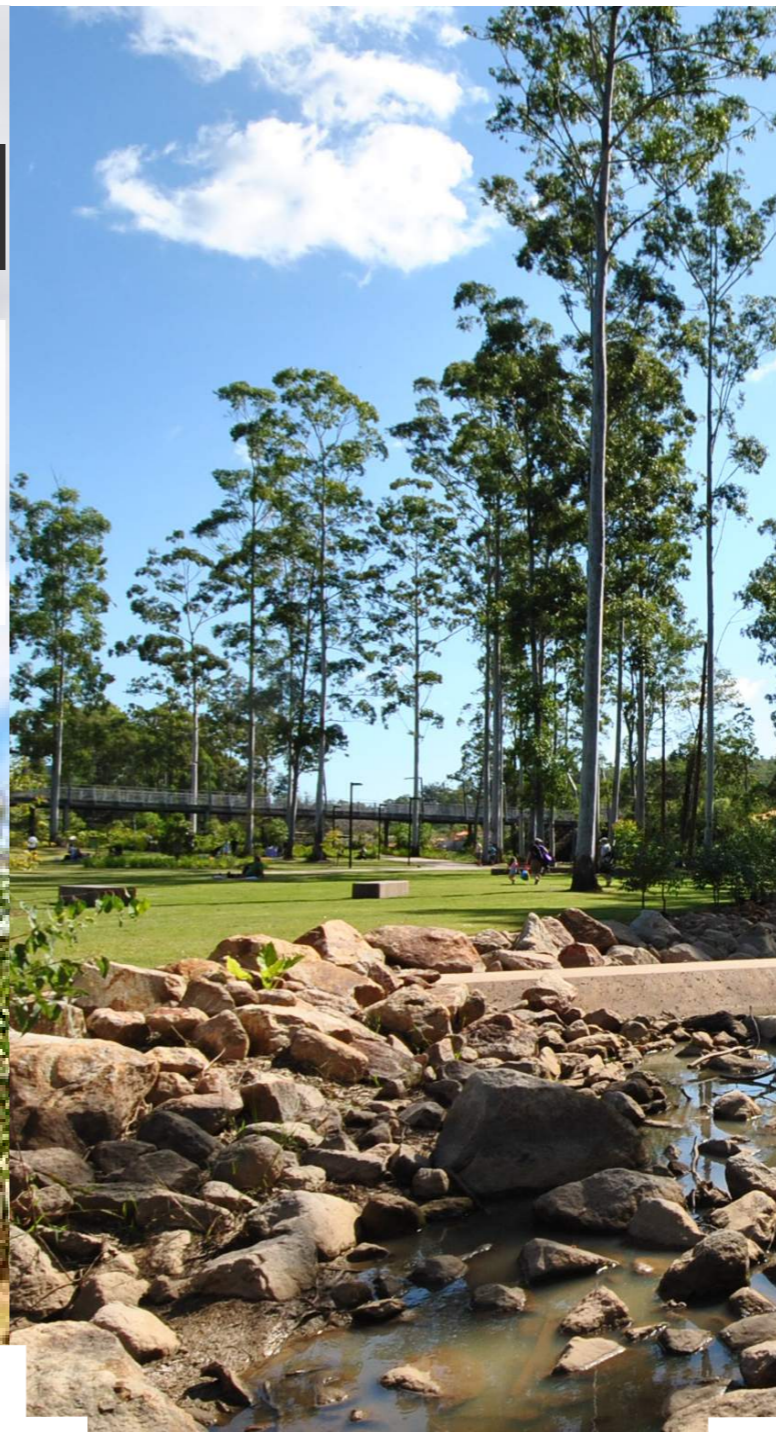



SCULPTURAL LANDFORM

3

BENCHMARK PROJECTS

- Garden of Cosmic Speculation (Scotland)

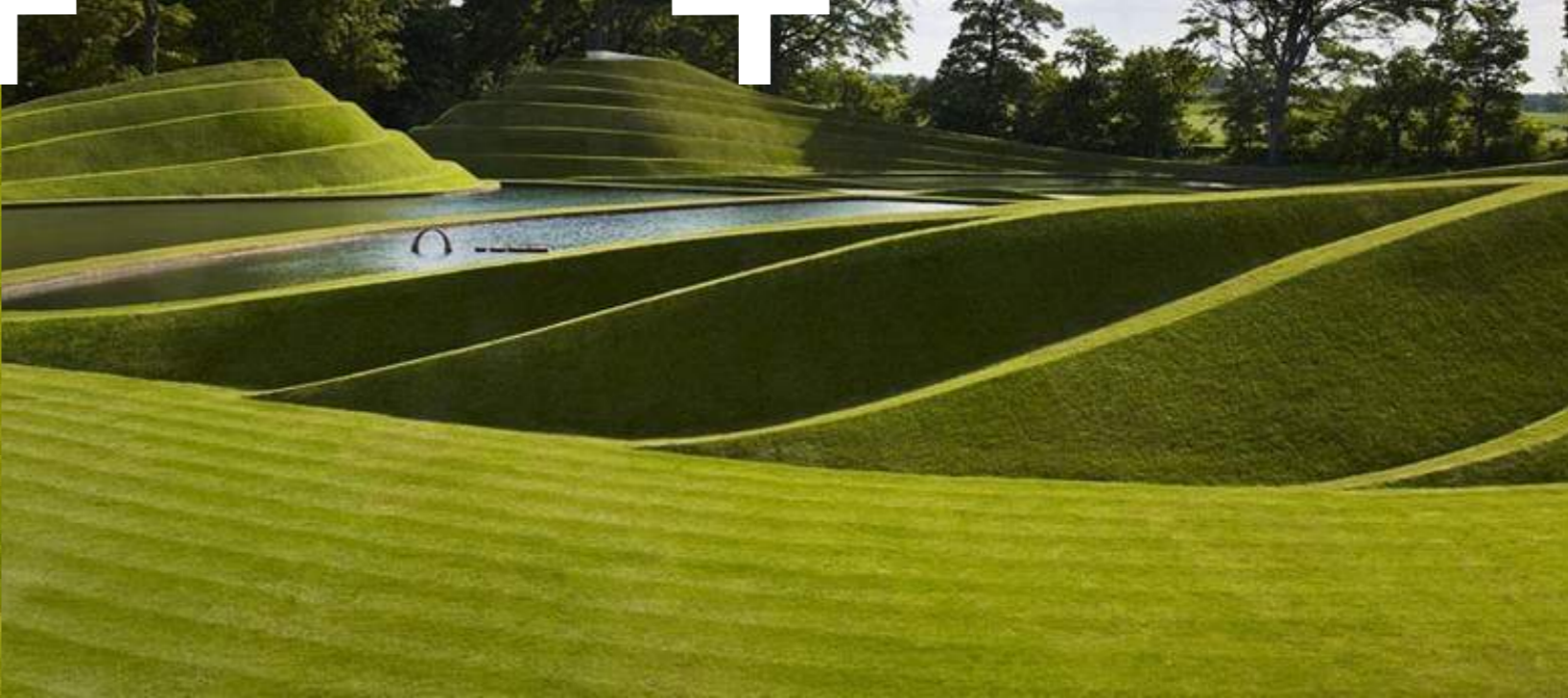

BENCHMARK PROJECTS

Interactive waterplay

- Rocks Riverside (Brisbane)
- Australian Garden (Melbourne)
- Darling Quarter (Sydney)

Natural Play

- Lizard Log Park (Sydney)





## 03 A PLACEMAKING STRATEGY

The essence of truly great parks lies in the placemaking of the landscape concept to create a deep felt sense of attachment by the community. In order to shape the way the community experiences Kershaw Gardens the following placemaking themes have been developed to ensure a meaningful environment is created and supports the design intent of delivering a 'big backyard' for all people. These placemaking themes have informed all elements of the design approach to create unified and responsive outcomes for the community of Rockhampton.



# A CANVAS OF CONNECTED AND INCLUSIVE SPACES

1

Sculptured spaces are intuitively connected to create a welcoming invitation for people to come and enjoy everything Kershaw Gardens has to offer. Through its revitalisation it will deliver a destination parkland where you can enjoy the natural environment in a family friendly setting. In all corners it will offer high performing spaces connected by a network of active recreation pathways for the community to use and explore everyday.



ANCHORED FOR CPTED



A HIERARCHY OF SPACES AND PATHS

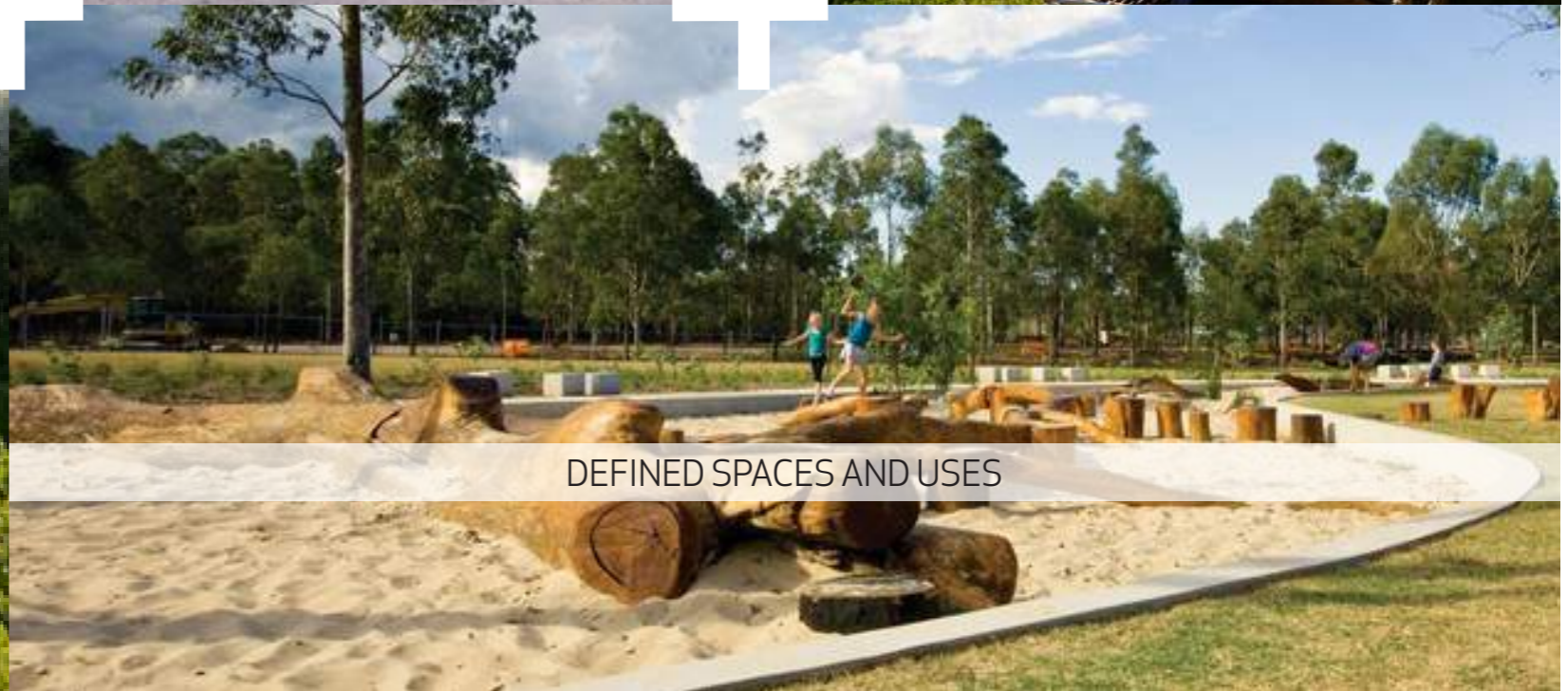

DEFINED SPACES AND USES

## AN INTERACTIVE AND FLEXIBLE NATURAL ENVIRONMENT

# 2

As Kershaw Gardens undergoes transformation, it is essential that new and existing environs are enhanced by providing a multi-function overlay that allow users flexibility to adapt and change functions on a daily basis. This will allow a full spectrum of uses to be integrated into the gardens to maximise latent potential and truly knit the landscape into the fabric of the community.



A SENSE OF DISCOVERY



A PLACE OF OPPORTUNITY



MULTI-USE FUNCTION FOR ALL PEOPLE



A NARRATIVE OF PEOPLE, PLACE AND COMMUNITY

3

A sense of stewardship and belonging will be enhanced through an interlaced web of functional open spaces, outdoor rooms and playgrounds that create and encourage interaction within the community.



COMMUNITY GATHERING SPACES



MARKERS OF NATURE AND HISTORY



DEFINED RELATIONSHIPS OF USE

## 04 VISION FOR THE FUTURE

---

**A SPACE  
FOR ALL**

Kershaw gardens will be a people's place, a place of excitement with unexpected gems that reveal themselves along a meandering network of paths. Creating a sense of discovery for all that frequent it, Kershaw Gardens will provide the community with a truly engaging landscape for respite, recreation and social and community gatherings.

**ROCKYS BIG  
BACKYARD**







ARTIST IMPRESSION - PASSIVE WATERPLAY

## 05 DESIGN CONCEPT

---

### THE SPATIAL THREADS

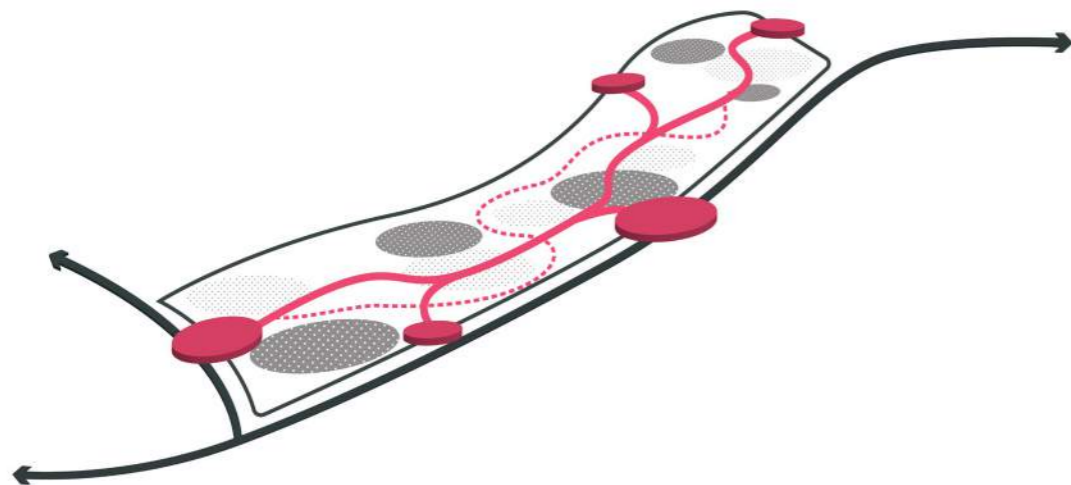

### THE LANDSCAPE CONFETTI

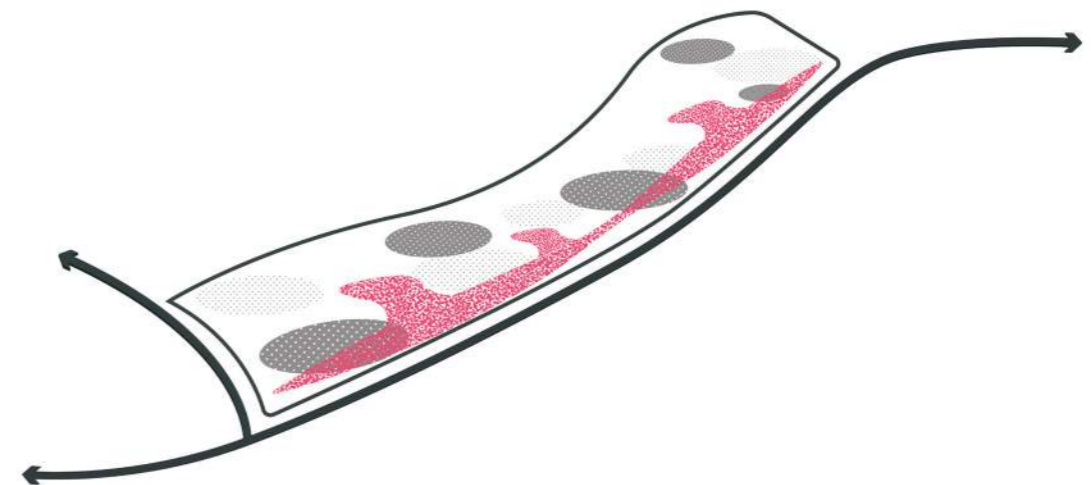

## THE UNDULATING SERPENTINE

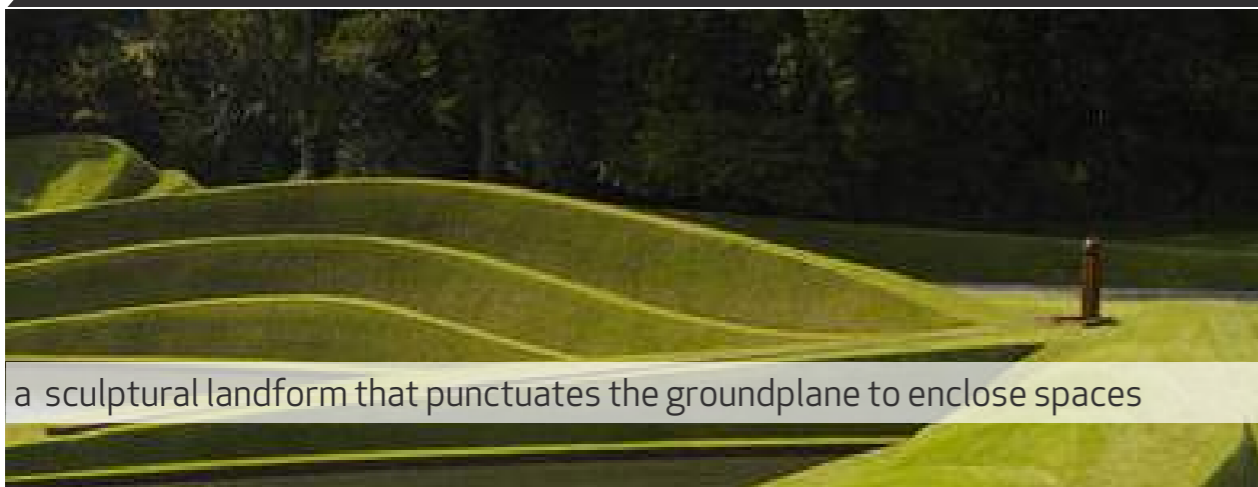

a sculptural landform that punctuates the groundplane to enclose spaces

## THE COOLING RIBBON

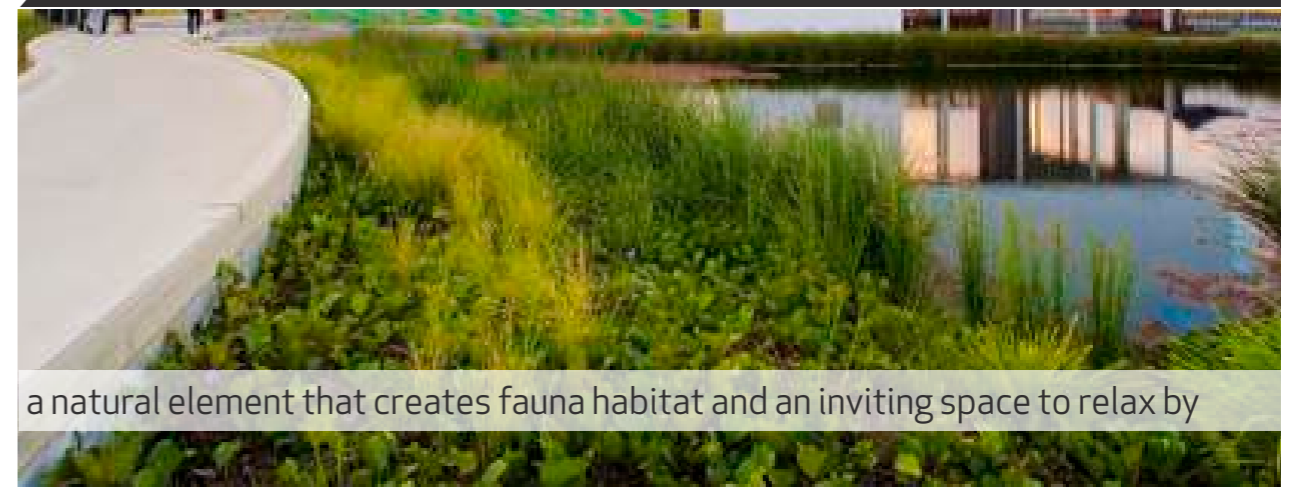

a natural element that creates fauna habitat and an inviting space to relax by

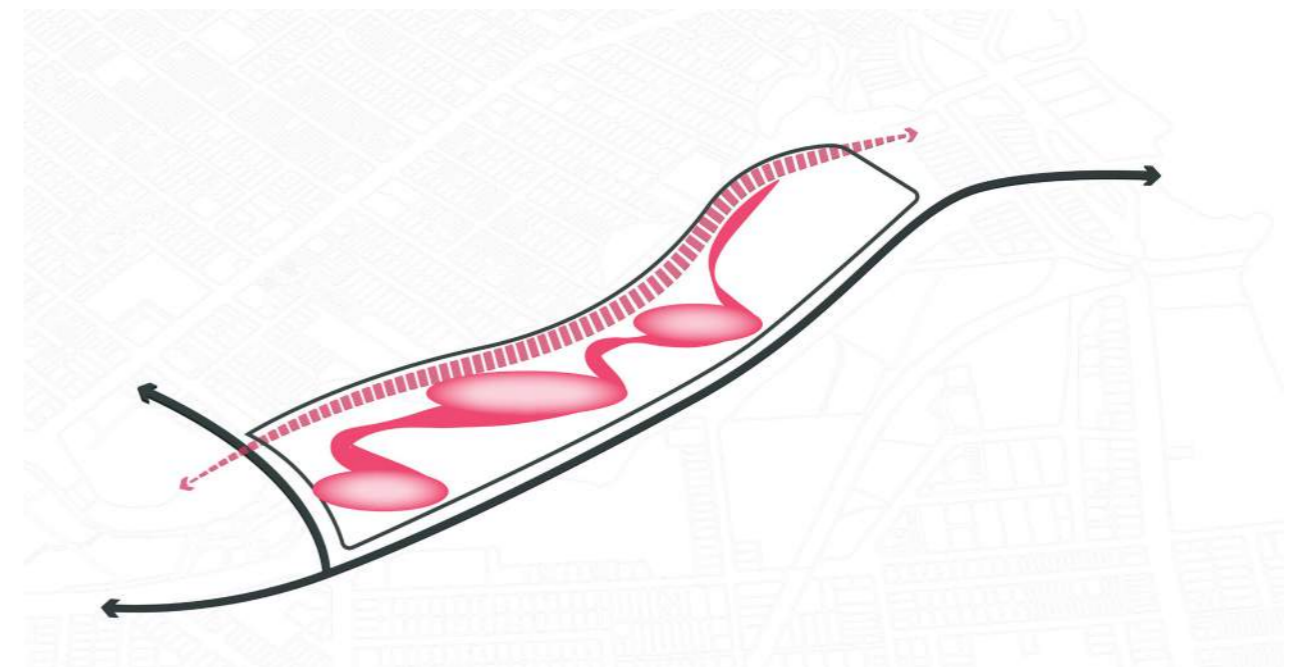

## 06 LANDSCAPE MASTERPLAN

---



ARTIST IMPRESSION - SHADED OPEN SPACE, MOUNDING AND ROCKBED



NATURE PLAY



PASSIVE WATERPLAY



## NORTH PRECINCT

---

### KEY ELEMENTS

- 1 THE RESERVE - Northern entry gateway in a natural setting
- 2 THE WATERFALL - An engaging waters edge that provides various photo opportunity
- 3 THE ROCK BED - A rock creek bed that provides opportunity to sit by and relax
- 4 THE COMMUNITY LAWN - An open space at scale appropriate for community events
- 5 THE WETLANDS - A low lying ephemeral waterbody that creates new habitat for fauna

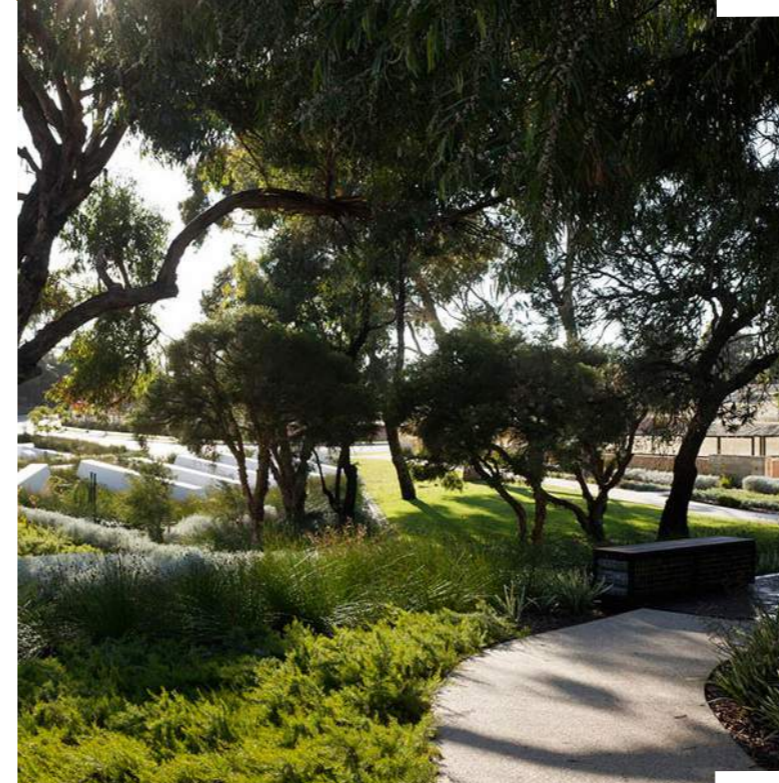



THE RESERVE

THE WATERFALL

THE ROCK BED

COMMUNITY LAWN

THE WETLANDS

## CENTRAL PRECINCT

---

### KEY ELEMENTS

- 1 RESPITE LAWN - A small open space shaded by trees
- 2 THE ROCKBED - A rock creek bed that provides opportunity to sit by and relax
- 3 WATERPLAY - A series of water elements for children of all ages to interact with
- 4 PLAY LAWN - A kick about open space perfect for ball games and active recreation
- 5 MAZE - A landscaped maze incorporated into the existing garden

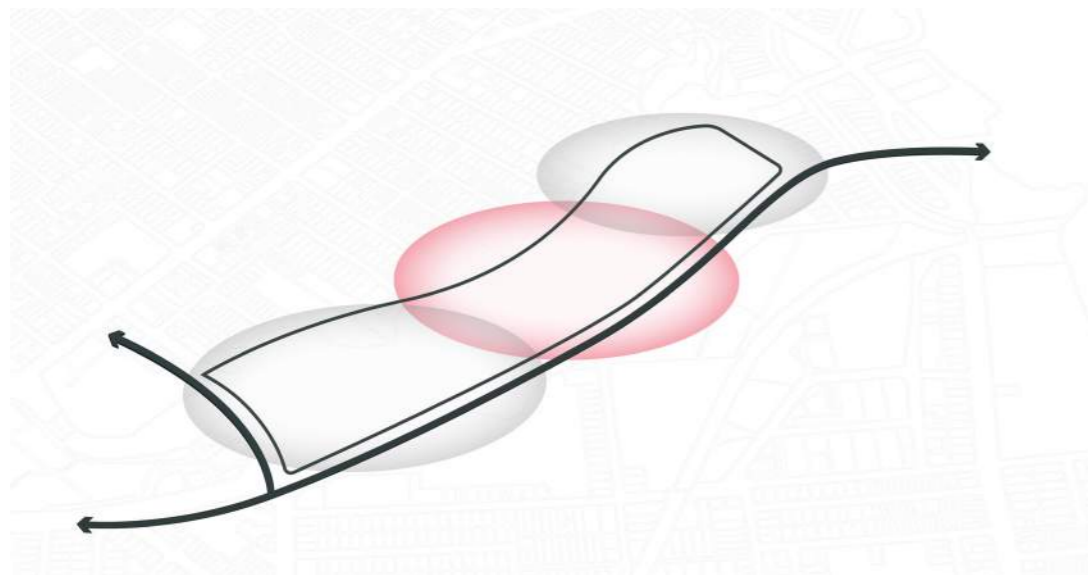



RESPIRE LAWN

WATERPLAY

THE ROCKBED

CARPARK

MAZE

NATURE PLAY

PLAY LAWN

CARPARK

## SOUTH PRECINCT

---

### KEY ELEMENTS

- 1 THE RAPIDS - Existing water element to be enhanced
- 2 THE ROCKBED - A rock creek bed that provides opportunity to sit by and relax
- 3 ACTIVE REC - A kick about open space and forest running track
- 1 DOG PARK - A small open space with agility elements for dogs

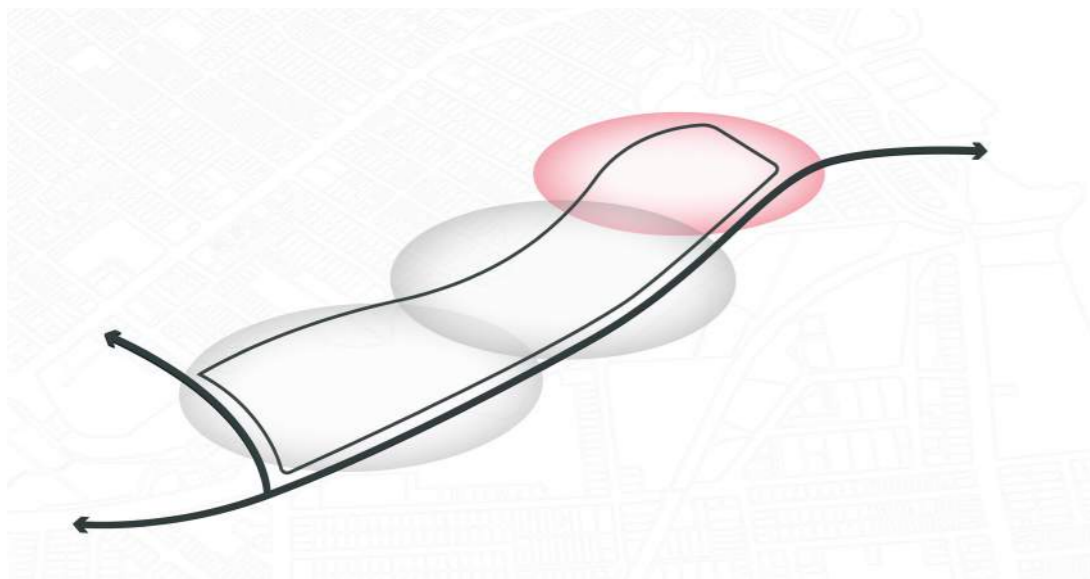



CARPARK

THE RAPIDS

THE ROCKBED

CARPARK

ACTIVE REC

DOG PARK

## 07 STRATEGIES FOR CHARACTER AND DETAILS

---

The cohesion, integration and interplay of the following landscape components represent the fine grain richness of the landscape that will contribute to the overarching desired outcomes. In a pragmatic sense, the design of individual components is intended to primarily offer amenity to users and instil a sense of uniqueness and quality into the landscape that draw inspiration from the natural and cultural environment.

## MATERIALITY

---

The hardscape of Kershaw Gardens will create a truly natural setting that is defined by earthy tones and rich textures. The design and application of the material palette will be manageable from a maintenance perspective with clean detailing that creates a sense of simplicity within the landscape.

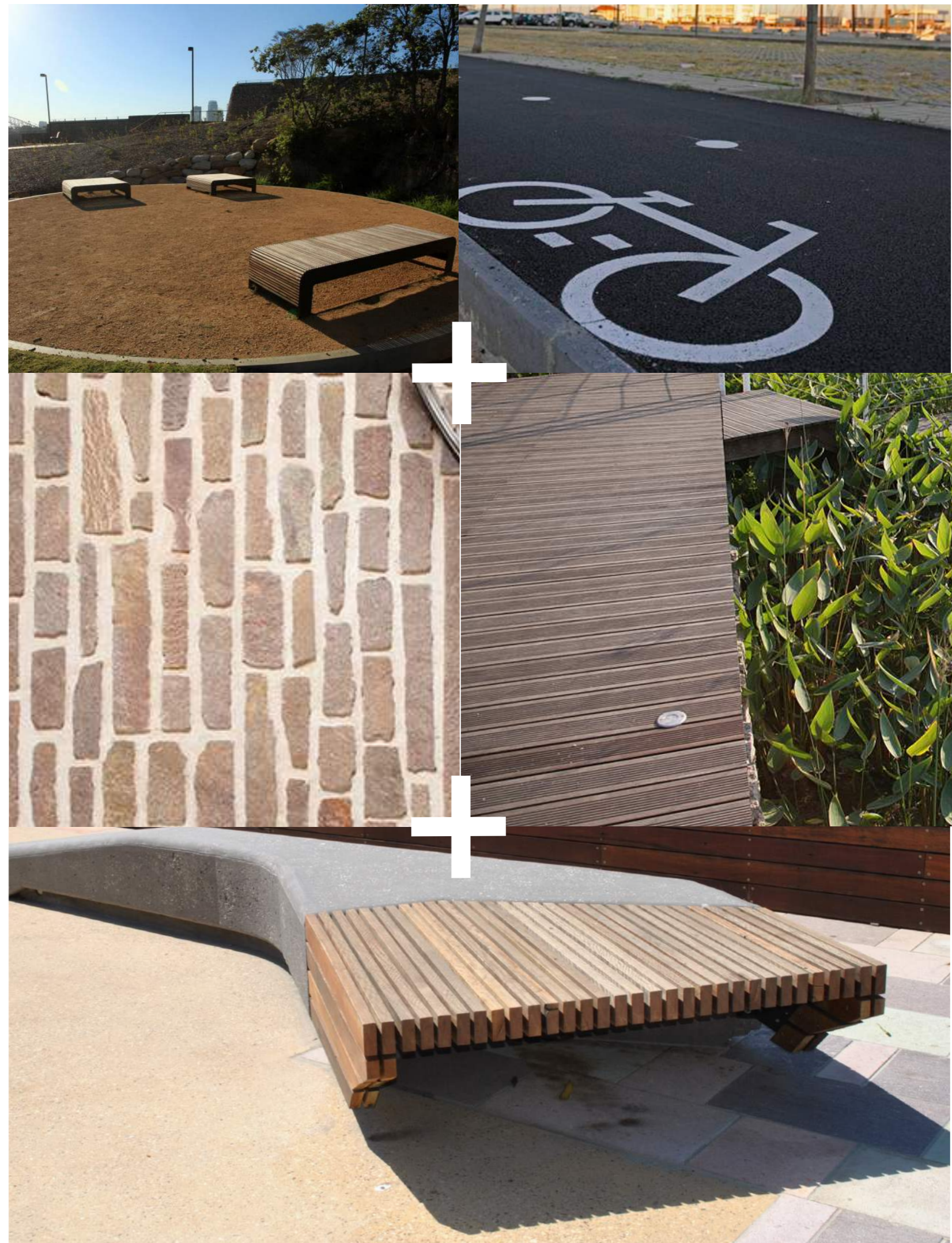

## PATHS

---

The hierarchy of the path network is defined by the materiality and dimension of the pathways. Primary paths will comfortably support high volume usage and service vehicles. Secondary paths allow for usage by cyclist and pedestrians whilst minor paths provide connections primarily for pedestrians.

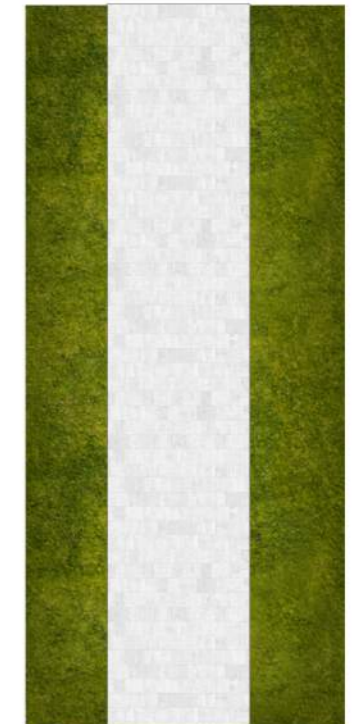
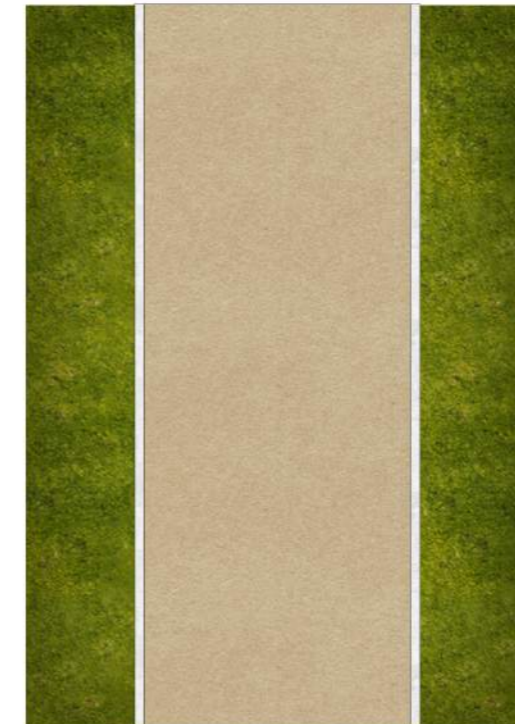
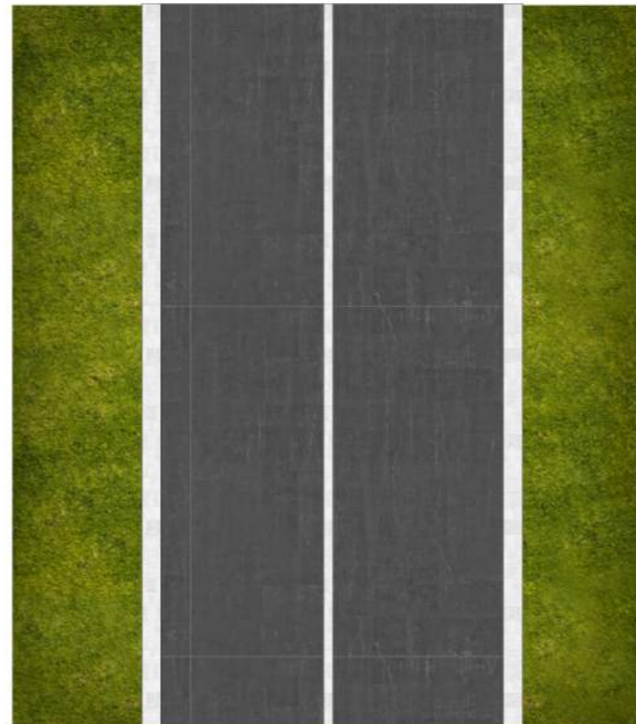

## FURNITURE AND ELEMENTS

A comprehensive and unifying landscape furniture suite will provide a distinctive character for Kershaw Gardens. Seating, signage, bins and lighting create a sense of cohesion in the landscape that amplify the sites natural setting through form and materiality.



## LANDSCAPE PAVILIONS

---

An architectural suite of landscape pavilions will deliver visually exciting shade structures providing comfort and shelter. The three variations provide a hierarchy in their usage including;

- the entertainment pavilion that accommodates dining and lounging with the greatest capacity,
- the dining pavilion which accommodates smaller gatherings and dining, and
- the garden pavilion which is focused around retreat and relaxation.





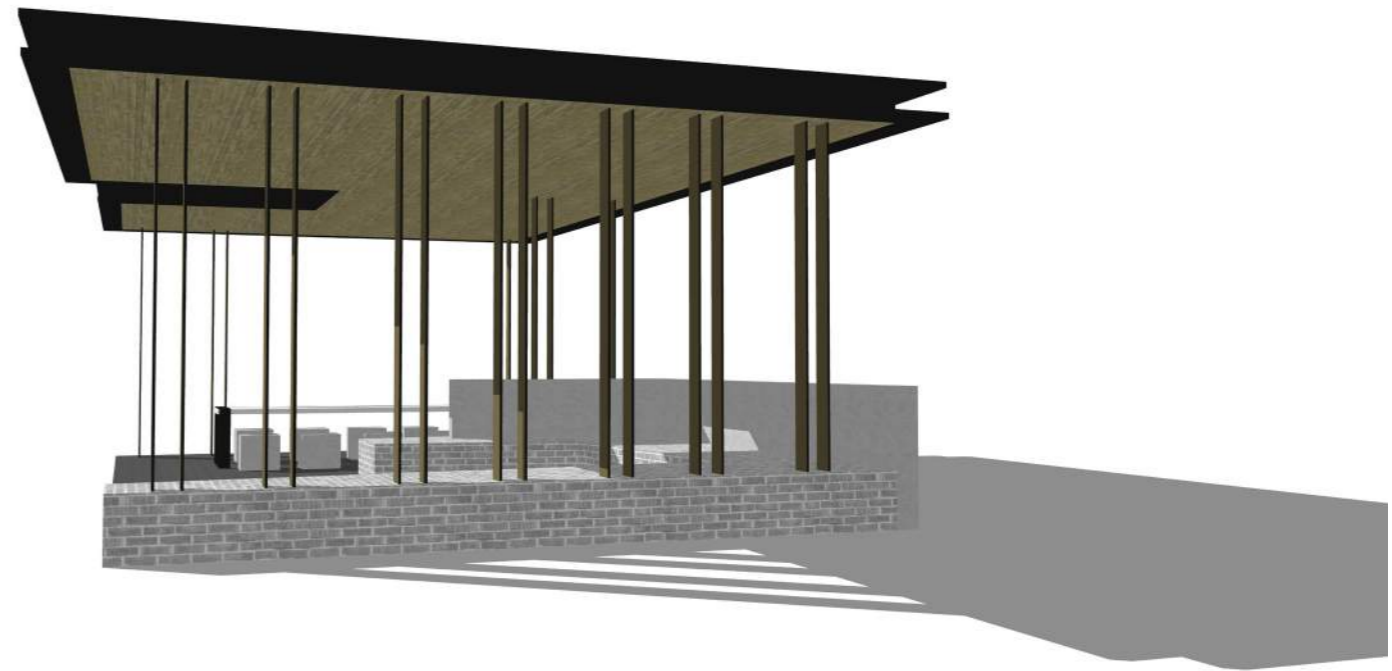

## PLANTING

---

The planting will boast a display of flowering shrubs and trees that deliver a seasonal colour display offering visitors visual interest and delight. It will help create a richly coloured landscape that reinforces the vibrancy of our natural flora. A unique combination and variety of colours, enhanced by the deep tones of figs and subtle greys of eucalypts will be used in manner that creates zones of different colour. From vibrant yellows and oranges to the elegance of pinks and purples and pops of red, the planting throughout the precinct will be dramatic, engaging and a true spectacle of endemic species.

### Trees

*Acacia melanoxylon*

*Acmena smithii*

*Araucaria cunninghamii*

*Archontophoenix cunninghamiana*

*Argyrodendron trifoliolatum*

*Brachychiton acerifolius*

*Castanospermum australe*

*Cupaniopsis anacardioides*

*Eleocharpus grandis*

*Eucalyptus tessellaris*

*Ficus macrophylla*

*Ficus obliqua*

*Flindersia australis*

*Harpullia pendula*

*Grevillea baileyana*

*Livistona australis*

*Melaleuca quinquinervia*

*Pandanus tectorius*

*Waterhousia floribunda*

### Shrubs

*Alcantarea imperialis 'Rubra'*

*Asplenium australasicum*

*Banksia robur*

*Callistemon pachyphyllus*

*Cordyline rubra*

*Cordyline petiolaris*

*Cyathea cooperi*

*Crinum pedunculatum*

*Cycas revoluta*

*Licuala ramsayi*

*Melaleuca thymifolia*

*Melastoma affine*

*Pittosporum 'Miss Muffett'*

*Rhapis excelsa*

*Westringia 'Wynyabbie Gem'*

*Zamia furfuracea*

### Groundcovers

*Alpinia caerulea*

*Callistemon 'little john'*

*Carpobrotus glaucescens*

*Chrysocephalum ramosissimum*



## WETLANDS

---

Kershaw Gardens provides an opportunity to demonstrate environmental processes and habitat creation in a manner that is educational for the community. The primary focus of the wetlands is to preserve and enhance natural systems through environmental linkages that will encourage fauna activity.

The wetlands will provide an additional recreational destination within the gardens that will be a perfect spot for casual retreat and bird watching.

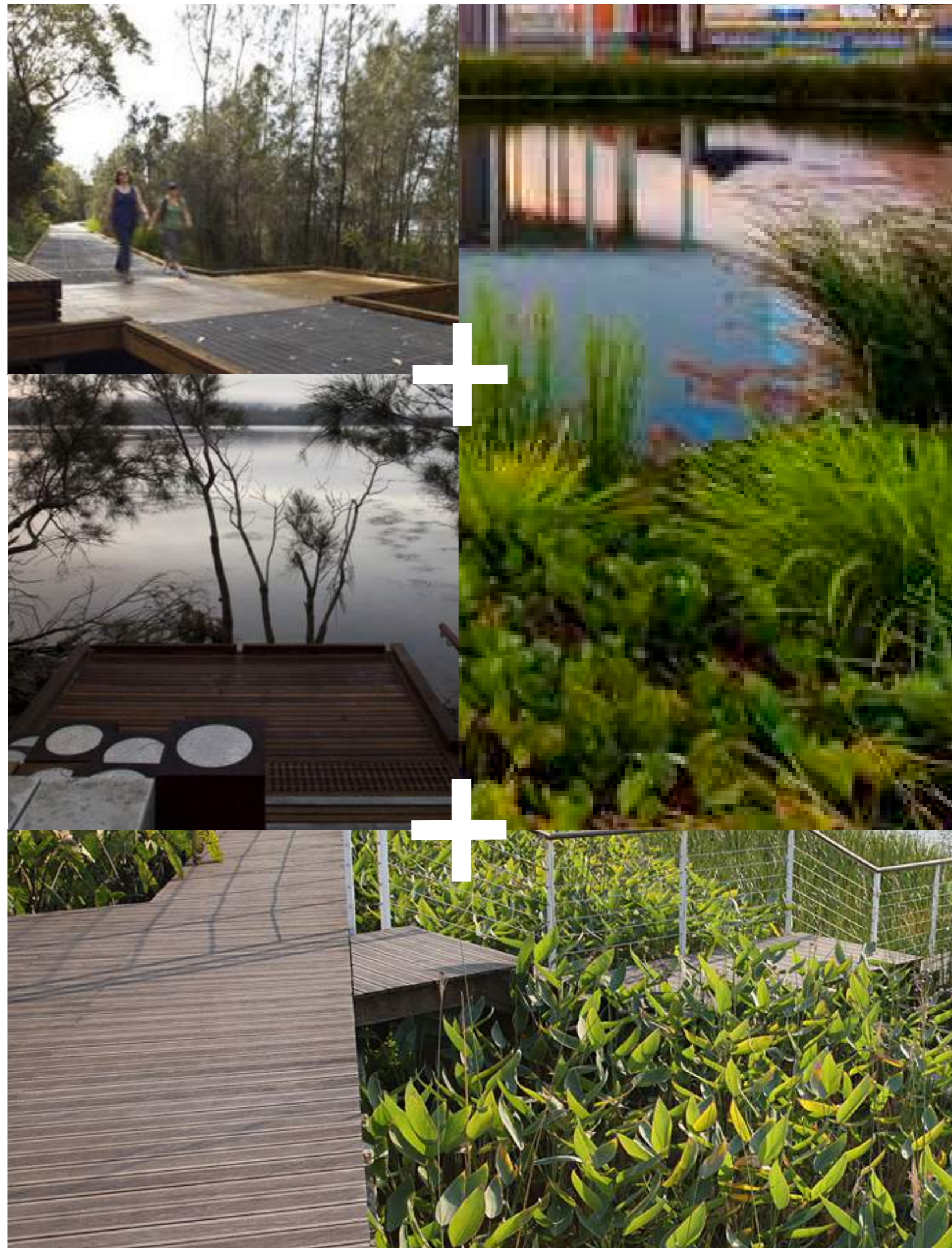

## CREEK

---

A major component of Kershaw Gardens that is underutilised as a key amenity driver is Moores Creek. The revitalisation of Moores Creek in conjunction with the wetlands creates an excellent opportunity to create a water system that has recreational and ecological roles. The provision for a series of board walks, landscape pavilions for respite and edges that encourage interaction will provide infinite possibilities for community usage and engagement with the natural system.



## NATURE PLAY

---

The nature play will be interactive and re-image natural materials and elements for all ages to use. The space will be supportive of natural surveillance and provide parents with a comfortable environment to sit and observe.



## PASSIVE WATER PLAY

The waterplay component of Kershaw Gardens will be a hive of activity. Based on a natural environment the space will be highly shaded for user comfort and safety.



**Sydney**

Level 23, Darling Park Tower 2  
201 Sussex Street  
Sydney, NSW 2000  
t 02 8233 9900  
f 02 8233 9966

**Melbourne**

Level 12, 120 Collins Street  
Melbourne VIC 3000  
t 03 8663 4888  
f 03 8663 4999

**Brisbane**

Level 7, 123 Albert Street  
Brisbane QLD 4000  
t 07 3007 3800  
f 07 3007 3811

**Perth**

Level 1, 55 St Georges Terrace  
Perth WA 6000  
t 08 9346 0500  
f 08 9221 1779

Australia • Asia • Middle East  
[www.urbis.com.au](http://www.urbis.com.au)  
[info@urbis.com.au](mailto:info@urbis.com.au)

